

Public Document Pack



Date: 17 March 2014
Ask For: Anona Somasundaram
Direct Dial: (01843) 577046
Email: anona.somasundaram@thanet.gov.uk

JOINT TRANSPORTATION BOARD

27 MARCH 2014

A meeting of the Joint Transportation Board will be held at **7.00 pm on Thursday, 27 March 2014** in the Council Chamber, Cecil Street, Margate, Kent.

Membership:

Councillor Clark (Chairman); Councillors: Aldred, Dwyer, K Gregory, S Hart, D Saunders, M Saunders, Savage, M Elenor (Kent County Council - Margate & Cliftonville), J Elenor (Kent County Council - Margate West), Heale (Kent County Council - Ramsgate), Latchford (Kent County Council - Birchington and Villages) (Vice-Chairman), W Scobie (Kent County Council - Margate and Cliftonville Electoral Division), Shonk (Kent County Council - Ramsgate), Terry (Kent County Council - Broadstairs and Sir Moses Montefiore), Wiltshire (Kent County Council - Broadstairs and Sir Moses Montefiore Electoral Division) and Councillor Sheila M P Bransfield (Thanet Area Local Councils' Committee)

A G E N D A

- | <u>Item No</u> | <u>Subject</u> |
|----------------|--|
| 1. | <u>APOLOGIES FOR ABSENCE</u> |
| 2. | <u>DECLARATIONS OF INTEREST</u> |
| 3. | <u>MINUTES OF PREVIOUS MEETING</u> (Pages 1 - 6)
To approve the Minutes of the Joint Transportation Board meeting held on 19 December 2013, copy attached. |
| 4. | <u>WESTWOOD RELIEF STRATEGY - WIDENING OF POORHOLE LANE AND ASSOCIATED JUNCTION IMPROVEMENTS</u> (Pages 7 - 14) |
| 5. | <u>PETITION: BROADSTAIRS SCHOOLS ROAD SAFETY</u> (Pages 15 - 16) |
| 6. | <u>CLIFFSEND TRAFFIC CALMING PROPOSALS AND PUBLIC CONSULTATION RESULTS</u> (Pages 17 - 24) |
| 7. | <u>ZEBRA CROSSING - NORTHUMBERLAND AVENUE, MARGATE</u> (Pages 25 - 28) |
| 8. | <u>HIGHWAY WORKS PROGRAMME 2014/15</u> (Pages 29 - 44) |
| 9. | <u>FIND AND FIX WEATHER DAMAGE REPAIRS</u> (Pages 45 - 46) |

Item
No

Subject

10. **TRAFFIC MANAGEMENT - PARKING AND WAITING RESTRICTIONS - THANET**
(Pages 47 - 82)
11. **PARKING AND WAITING RESTRICTIONS UPDATE SUMMARY** (Pages 83 - 86)
12. **DATE OF NEXT MEETING**
The next Board meeting will be held on Thursday, 12 June 2014.

JOINT TRANSPORTATION BOARD

Minutes of the meeting held on 19 December 2013 at 7.00 pm in Council Chamber, Cecil Street, Margate, Kent.

Present: Councillor Douglas W Clark (Chairman); Councillors Latchford (Kent County Council - Birchington and Villages) (Vice-Chairman), Aldred, Dwyer, K Gregory, S Hart, D Saunders, M Saunders, Savage, M Elenor (Kent County Council - Margate & Cliftonville), J Elenor (Kent County Council - Margate West), W Scobie (Kent County Council - Margate and Cliftonville Electoral Division), Shonk (Kent County Council - Ramsgate), Terry (Kent County Council - Broadstairs and Sir Moses Montefiore), Wiltshire (Kent County Council - Broadstairs and Sir Moses Montefiore Electoral Division) and Hovenden (Cliffsend Parish Council) (*substitute for Councillor Bransfield*)

In Attendance: Paul Valek, District Manager, Kent County Council Highways and Transportation
Kelly Garrett, Safety Critical Schemes Engineer, Kent County Council Highways and Transportation
Charlotte Owen, Smartcard Project Manager, Kent County Council Highways and Transportation
Nina Peak, Partnership Manager, South Eastern Railway
Robin Chantrill-Smith, Civil Enforcement Manager, Thanet District Council

CHAIRMAN'S INTRODUCTORY REMARKS

The Chairman made the following announcement:

"Members often raise various Highways and Transportation matters at meetings of the Joint Transportation Board (JTB). However, ad hoc requests not on the agenda should not be addressed at the JTB but must follow the process of investigation within the Kent County Council (KCC) Highways and Transportation's current reporting systems before coming to JTB in the form of reports for decision or information purposes.

"General highway enquiries that include requests for improvements or changes to the highway should be logged through our contact centre on 03000 418181 or through our on line fault reporting tool at www.kent.gov/highways . This is the quickest way to raise concerns or receive information and ensures the necessary audit trail is set up and the enquiry is routed to the appropriate officer. Enquiries are given a unique reference number which can be used to track the progress of the enquiry either on line or through the contact centre. When logging enquiries requests can be made for a call back or a written response and there is the ability to highlight that the issue has been raised by a County, District or Parish Councillor.

"Of course, the District Manager, Paul Valek, and his team are always available for issues that you feel direct contact or site meetings are needed."

In response to a Member's query regarding issues that are the responsibility of Thanet District Council, Robin Chantrill-Smith confirmed that Members should continue to raise those matters with him.

Tribute was paid to KCC Highways and Transportation on their effective reporting system and to Paul Valek and his team for always responding so promptly.

It was **AGREED** that the wording of the Chairman's announcement be circulated to other Board Members.

20. APOLOGIES FOR ABSENCE

Apologies for absence were received from Mr Martyn Heale, Kent County Councillor and Councillor Sheila Bransfield (*for whom Councillor Vera Hovenden was present as substitute*).

21. DECLARATION OF INTERESTS

There were no declarations of interest

22. MINUTES OF PREVIOUS MEETING

On the proposal of Councillor D Saunders, seconded by Councillor K Gregory, the minutes of the meeting held on 3 September 2013 were approved and signed by the Chairman.

23. MATTERS ARISING

(a) **Westwood Relief Strategy - widening of Poorhole Lane and associated junction improvements**

It was NOTED from Paul Valek, District Manager, Kent County Council, Highways and Transportation, that it had not been possible to finalise a report in time for submission to this meeting; however, a report would be brought to the next meeting of the Board, on 27 March 2014.

24. MARGATE AND RAMSGATE RAILWAY STATION FORECOURT ENHANCEMENTS - LOCAL SUSTAINABLE TRANSPORT FUND

Scheme for MARGATE Railway Station Forecourt

In speaking under Council Procedure Rule 24.1, Councillor King stated that he had found the drawing of the Margate Station Forecourt enhancements (Annex1) harder to follow than the drawing for Ramsgate station (Annex 2).

He enquired as to what the yellow rectangles to the right of the drawing represented and how many taxi ranks were proposed in the new design. He also commented that two of the three pedestrian crossings illustrated on the drawing appeared to go up the road rather than across.

Nina Peak, Partnership Manager, Southeastern Railway, displayed a clearer drawing of the scheme (*drawing now published as part of the details for this meeting*).

She reminded Members of the purpose of the scheme; namely, to help promote Margate as part of Thanet Regeneration by making the station more welcoming and providing better connectivity and improved transport interchange for rail commuters. She advised that features of the scheme would include: an improved walking route; improved surfacing in the form of paving; two parking places for buses; adjusted kerb heights for 'step-free buses'; '20-minute' waiting bays; and planting of new trees. She added that the 'disabled parking bays' would be moved back a bit from the front of the station building, with the new location still being considered safe and convenient, and that the number of taxi ranks would be reduced from ten to eight.

Members then asked questions in relation to the scheme, and Nina Peak responded by providing the following information:

1. If it was found, during the course of time, that more than eight taxi ranks were required, part of the 'drop-off area' could be used to create new ranks.
2. Thanet District Council's tree officer was being consulted on what type of trees should be planted. The number of trees planted would exceed the number of trees removed.
3. The number of disabled parking bays would remain the same and the accessible parking bays would be built to the Department for Transport (DfT) specification for size and access zones.
4. The size of non-disabled parking places would be standard by National Rail's terms.
5. There would be signage both on the road and on signs, and Paul Valek, District Manager, KCC Highways and Transportation, advised that the road markings should last several years.
6. There would be five, 20-minute waiting bays and these would be free of charge.

A Member expressed reservation about the maintenance budget being sufficient to replace features on a like-for-like basis.

Scheme for RAMSGATE Railway Station Forecourt

Nina Peak outlined the main elements of the scheme, after which the following issues were raised by Board Members:

Did the enhancement scheme for Ramsgate station not conflict with proposals to install a new parkway station at Manston? Also, should Mr David Brazier, Kent County Council Cabinet Member for Transport & Environment, be requested to provide the Board with details of plans for the parkway station?

In response, Nina Peak stated that she understood that the parkway station would not be in place for several years. In her view, it was important to address safety issues in the vicinity of Ramsgate station not only for the benefit of commuters who would continue to use that station, but also for the benefit of residents who needed to walk across Station Approach Road. She added that, according to statistical analysis, the number of persons using Margate and Ramsgate stations had increased over the previous year.

It was proposed by Councillor K Gregory, seconded by Councillor Dwyer and **AGREED** that the report be noted and that the commencement of consultation on the proposed changes to Station Approach Road, Ramsgate be approved.

25. PETITION: BROADSTAIRS SCHOOLS ROAD SAFETY

The report was **NOTED**.

26. CLIFFSEND TRAFFIC CALMING PROPOSALS AND PUBLIC CONSULTATION RESULTS

Kelly Garrett, Safety Critical Schemes Engineer, KCC Highways and Transportation, presented her report and in a discussion that ensued the following points and questions were raised by Members:

1. Cliffsend was not a typical English village in that it was divided by a carriageway;
2. What were the relative distances of the new East Kent Access Phase 2 (EK2A) roads and Sandwich Road and Canterbury Road West?

Kelly Garrett stated that she did not have that information to hand, but would provide it direct to Mr J Elenor. She pointed out that she did not consider the roads to be comparable in that the new roads were dual-carriageway, whereas the 'old roads' were single-carriageway.

3. What was happening in relation to reducing the speed limit at Cottington Bridge?

Paul Valek, District Manager, KCC Highways and Transportation, reported that additional drainage measures had now been put in place, the settlement was being monitored and had now stopped. It was anticipated that the area would be resurfaced in Spring 2014. All associated costs were being borne by the Contractor.

4. If a major accident occurred at the Lord of the Manor roundabout, would serious traffic disruption not ensue?

Kelly Garrett pointed out that Canterbury Road West and Sandwich Road would still be available for use; indeed, the choice of roads at the present time was greater than had previously been the case.

5. Were drivers not being forced to use the new Heignst Road purely on the basis that it was considered that not enough people were using it?

Kelly Garrett stated that the primary objective behind the new EKA2 road development had been to open up Thanet for investment. A by-product of that objective was to return Canterbury Road West and Sandwich Road to residential use.

She also pointed out that measures would be put in place to enhance traffic flow at the Lord of the Manor signalled gyratory.

It was proposed by Mr Terry and seconded by Councillor K Gregory:

"THAT the next steps as outlined in paragraph 6.1 of the report be approved, namely:

- a) Carry out various traffic surveys;
- b) Continue to monitor the effects of the Phase One trial works and make alterations where necessary;
- c) Progress the detailed design of the Phase Two works taking into consideration the consultation and exhibition results and the Phase One trial. Alterations will be made to the proposals where possible in line with the consultation and exhibition feedback and trial;
- d) Advertise the Traffic Regulation Orders for the proposed changes to the speed limits and parking restrictions;
- e) Report revised Phase Two proposals to the March 2014 meeting of this Board;
- f) Commence with the construction of Phase Two in Spring 2014."

Upon being put to the vote, this motion was declared **CARRIED**.

27. HIGHWAY WORKS PROGRAMME 2013/14

Paul Valek, District Manager, KCC Highways and Transportation, updated the programme verbally as follows:

Appendix A – Footway and Carriageway Improvement Schemes

There was an additional scheme, namely, resurfacing of roundabout between Bromstone Road and Rumfields Road, which had been COMPLETED.

Appendix C – Street lighting

Councillor K Gregory asked how many more street lighting columns were outstanding. Paul Valek undertook to provide this information to Councillor Gregory.

Appendix D – Developer Funding Works: waiting restrictions and highway works for new doctors' surgery, Grange Road, Ramsgate

Mr Shonk suggested that waiting restrictions should be introduced outside the shops. Robin Chantrill-Smith, Enforcement Manager, Thanet District Council, advised that a loading bay would be put in place between Nos. 9 & 12 Grange Road.

Appendix E – Transportation and Safety Schemes: Pedestrian route improvements – Fort Road/Love Lane/King Street/Hawley Street, Margate

In response to a request by Mr W Scobie, Paul Valek undertook to let him see the plans.

Appendix G – Member Highway Fund: (?) Funding of additional TDC parking enforcement around the QEQM Hospital – Mr W Scobie

In answer to a query from Mr W Scobie, Robin Chantrill-Smith stated that he was unable to confirm, at this stage, that there would be budget capacity to extend this area of parking enforcement.

28. PARKING AND WAITING RESTRICTIONS UPDATE SUMMARY

The report was **NOTED**.

29. TRAFFIC MANAGEMENT - PARKING AND WAITING RESTRICTIONS - THANET

It was proposed by Councillor K Gregory, seconded by Mr W Scobie and **AGREED**:

1. THAT the recommendations shown in Annex 1 are approved;
2. THAT the proposals which require statutory consultation are advertised and that any traffic-related objections are reported back to a future meeting of the Board.

30. REPORTS TO MEETING OF KENT COUNTY COUNCIL ENVIRONMENT, HIGHWAYS AND WASTE CABINET COMMITTEE ON 3 OCTOBER 2013

- (a) **Report on Kent County Council's representations on recent district local plan consultations - Canterbury, Thanet and Swale Councils**

The report was **NOTED**.

(b) **Winter Service Policy for 2013/14**

The report was **NOTED**.

Meeting concluded : 8.15 pm

From: John Burr, Director of- Highways & Transportation

To: Thanet Joint Transportation Board

Date: 27 March 2014

Subject: **Poorhole Lane & Westwood Relief Strategy**

Classification: Unrestricted

Summary: Progress report on Poorhole Lane Improvement and the wider Westwood Strategy

For Information

Poorhole Lane Improvement

Introduction

At the 3 September 2013 meeting of this Board a report was given on the award of Department of Transport Pinch Point funding that would allow the Poorhole Lane component of the wider Westwood Strategy to proceed. This Report gives an update on scheme progress together with a broader overview on the development of the wider strategy. See Scheme Plan - Drawing No. 4300108/000/04 Rev 1 attached

The voluntary land negotiations have been successfully completed. The co-operation of the three landowners is gratefully acknowledged as without their support the Pinch Point funding may have been lost and the scheme unable to proceed in the short term. One land transfer has been formally completed and the remaining two are being actively progressed by solicitors.

Following submission of an environmental screening assessment, Kent County Council's Head of Planning Applications has given a Screening Opinion that a formal Environmental Impact Assessment is not required and that the scheme can proceed as Permitted Development. Thanet District Council has given consent for the removal of trees covered by Tree Preservation Orders.

Engineering surveys and the detailed design of the scheme has been completed.

Detailed discussion has been had with all utility companies and as anticipated in the earlier report, the diversion of their plant is going to be extensive although considerable effort is being made to minimise the work required.

Procurement

A list of five contractors to tender for the scheme has been selected following an assessment of their suitability and experience and in accordance with European procurement legislation.

Construction tenders were invited in early March and are due to be returned in April.

Programme

Site clearance of trees and scrub is currently underway. An advance contract was necessary in order to complete the bulk of the clearance before the start of the bird nesting season.

The construction tenders will be assessed in detail following their return. The aim will be to select a preferred contractor and award a construction contract in May. Following a period for the contractor to mobilise, a start of works in June is anticipated with completion in spring 2015. A firm completion date cannot be given at this time as much will depend on the contractor's view of the works and in particular the programming of utility diversions and the effects of any adverse winter weather.

Finance

The estimated cost of the scheme is £3.86m. This is significantly above the initial estimate of £2.24m that was given in the Pinch Point bid. The primary reason for the increase is the estimated cost of utility diversions that has now been established following the detailed scheme design and utility companies consequently being able to give a detailed view of the required diversions.

The County Council has agreed to provide the financial support required to allow the scheme to proceed. This was a difficult decision but was judged against the risk of losing the Pinch Point funding that requires expenditure to be completed by March 2015, the potential risk to the continued availability of the S106 contributions and the considerable uncertainty on when a further opportunity would be available for delivering this fundamental component of the wider Strategy for creating a circular route around Westwood.

	£
Pinch Point funding	1.562m
Developer S106	0.680m
KCC	1.618m
	<hr/>
	3.860m

Public Information

A Work Information notification was widely distributed prior to the start of the site clearance. Scheme Notice boards will be erected and a further notification will be given prior to the start of the construction works and measures will be put in place to ensure there is effective communication and liaison with local people, businesses and all road users throughout the roadworks construction period.

Westwood Strategy

Introduction

Kent County Council (KCC) and Thanet District Council (TDC) have been working together to improve the local economic condition by developing employment opportunities for Thanet's residents. The growth of Westwood Town Centre with the Westwood Cross Retail Development and Canterbury Christ Church University Campus, has helped the local economy and created a significant number of jobs for local people.

The success of these developments, however, has led to severe congestion at peak times during weekdays and Saturdays at the Westwood Roundabout as the intersection point of roads between Ramsgate, Broadstairs and Margate and at the heart of Westwood Town Centre. Thanet's two principle routes, the A254 and A256 converge at Westwood roundabout, creating a barrier to walking and cycling between different land parcels offering different retail outlets.

The Local Transport Plan for Kent 2011-2016 reports that Westwood Cross Roundabout has the highest number of crashes reported in Kent between 2007 and 2010 based on annual cluster reviews, with a "cluster" defined as six or more crashes within a 50m radius on roads with a 40mph or lower speed limit.

Improvements to the traffic flow through Westwood has been high on the agenda for several years and works have been carried out including the widening of existing roads and new roads approved from developer contributions to help disperse traffic more efficiently and improve journey times.

The Westwood Roundabout is significantly over capacity and this is leading to extremely long delays and unreliable journey times. As a result, traffic is experiencing severe delays on the A256 Westwood Road and the local community and businesses have raised considerable concerns about the impact of this severe congestion on their quality of life and business. In addition, the Thanet Loop (a well used circular bus service, operating in two directions every 7/8 minutes and linking the main Thanet settlements) has been severely disrupted with unreliable journey times and indeed one operator has withdrawn a route service.

KCC and TDC would like to see Westwood and Thanet continue to grow to increase employment opportunities and reduce the levels of deprivation. Despite improvements made to date, transport modelling of the area has demonstrated that future congestion and delay will be a stranglehold on the success of planned and future retail development.

KCC and TDC have developed a congestion relief strategy for the Westwood and Thanet area. The securing of Pinch Point Funding will enable the delivery of the Poorhole Lane and associated junctions scheme to be implemented by March 2015. This is considered as Phase 1 of the strategy and as reported above is currently progressing well.

The concept for the Westwood Relief Strategy is to provide a ring road around and through the retail area of Westwood and to relieve the convergence of traffic at the Westwood Roundabout. Most of the ring road is already in place or approved

comprising: the New Haine Road, the new link road through the Gleeson's site (between Haine Road and Nash Road), Star Lane and Poorhole Lane (after improvement works) and the proposed new Sainsbury's Link Road. The missing link is the connection between Margate Road and Westwood Road. One consideration would be to upgrade the Tesco internal link road to an adoptable highway standard and continue to maintain it as public highway. Tesco has given their initial support to the proposal and are willing to help take a scheme forward. Other options are also under consideration.

Developing a ring road around the Westwood area and subject to testing and KCC approval will give the opportunity to experiment with a closure of the Westwood roundabout to all traffic other than buses/taxis/cycles and pedestrians outside of peak hours, say between 10.00am and 4.00pm. This would effectively optimise the use of pedestrian desire lines between the different retail quadrants and offset the desire to "car park hop", thus reducing unnecessary extra trips around the retail area. It would reduce journey times for buses and enable better reliability, improve congestion and carbon emissions, optimise the economic benefit to the area and create a town centre environment.

Transport modelling has been carried out using the Thanet VISUM Model. The modelled network includes the necessary additional links to provide a complete network of routes around the Westwood Cross area with the central junction closed for general traffic.

By 2028, demand is expected to increase by 20% but model outputs suggests the revised network will operate at a lower level of saturation demonstrating that the proposed strategy more than accommodates the increase in demand. Queues will spread out across the network rather than focussing on one or two critical areas. Modelling was carried out with the permanent closure of the Westwood roundabout but the desired proposal is to keep the roundabout open during peak periods to better allow ease of movement when demand is at its highest.

Key Aspects

Tesco's internal access road may be required. Discussions with landowners have indicated an in principle willingness to give the land to KCC by voluntary negotiation. This very welcome support for the scheme needs to be confirmed by the completion of negotiations on land values (Tesco contribution) and the formal transfer of the land to KCC.

The road is currently open to all traffic but its construction is unknown and the degree of improvement necessary to be of an adoptable standard will need further investigation.

It is not yet known whether the scheme requires planning permission or can be delivered as Permitted Development.

A detailed topographical survey needs to be commissioned together with associated environmental, drainage and geotechnical surveys to allow the detailed design to be developed.

Westwood Road is likely to be a key utility corridor and identifying the impacts of the proposed roundabout junction and any required diversions or protection measures will be important aspects of scheme cost and programme, as will the KCC Lane Rental Scheme.

Scheme cost, construction procurement and construction period are key factors in affordability and target end date delivery and these aspects will be considered in detail in the coming months as the design is progressed by KCC's consultant's Amey.

Finance

KCC are undertaking initial feasibility work to get the scheme to a position whereby future funding opportunities can be taken full advantage of by having the scheme ready for implementation. KCC has included this proposal in the South East Local Enterprise Partnership (SELEP) Strategic Economic Plan.

Recommendations

FOR INFORMATION

Background Documents

Thanet VISUM Model - Draft Model Summary Report, November 2012

Contact details

Mary Gillett – Major Projects Planning Manager
mary.gillett@kent.gov.uk
01233 614084

John Farmer – Project Manager (Major Projects)
John.farmer@kent.gov.uk
07740 185252

This page is intentionally left blank

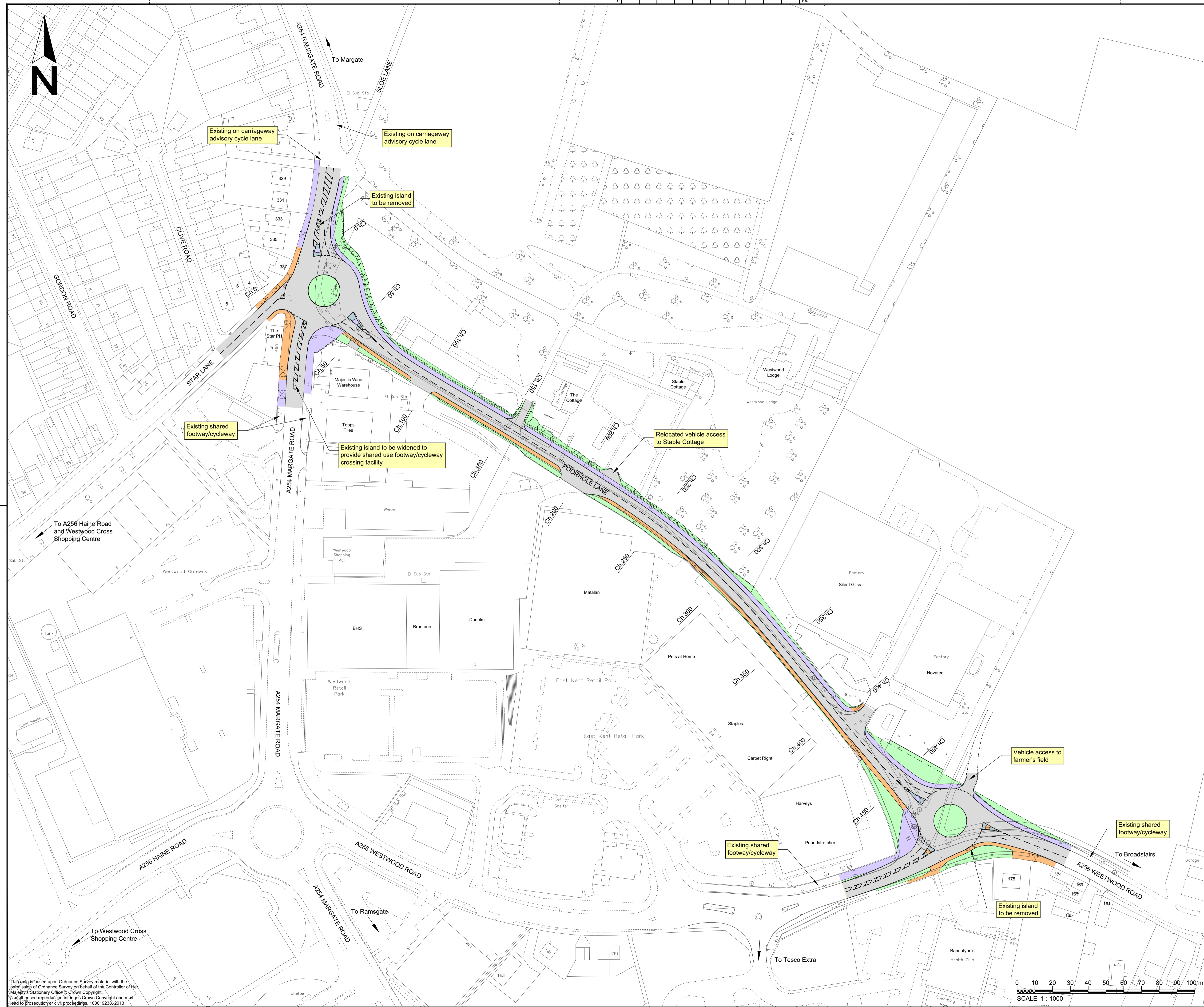

- Notes**
 1. All levels, datums and distances are shown in metres
- KEY**
- Carriageway Improvement
 - Verge / Earthworks / Landscaping
 - Footway
 - Shared Footway/Cycleway
 - Non Pedestrian Hardstanding
 - Existing Vehicle Access to be retained

1	Farm access off Westwood Roundabout added	RJHF	BS	02-12-13
Rev	Revision details	Chkd	Appd	Date
Drawn:	TMW			Preliminary
Design:				For comment
Chkd:	RJHF			For tender
Appd:	BS			For construction
Date:	19 NOV 13			As constructed
				Other



Client
 Project Name
POORHOLE LANE, WESTWOOD, THANET

Drawing Title
Scheme Plan

Original Drawing Size : A1	Dimensions : -
Scale : 1:1000	Copyright © Amey
Drawing No 4300108/000/04	Rev 1

This plan is based upon Ordnance Survey material with the permission of Ordnance Survey on behalf of the Controller of Her Majesty's Stationery Office © Crown Copyright. Unauthorised reproduction infringes Crown Copyright and may lead to prosecution or civil proceedings. 100018238:2013

This page is intentionally left blank

Broadstairs Schools Road Safety Petition

To: **Thanet Joint Transportation Board – 27th March 2014**

By: **Tim Read – Head of Transportation**

Classification: **Unrestricted**

Ward: **Broadstairs & Sir Moses Montefiore**

Summary: **Petition received by Kent County Council regarding Broadstairs Schools Road Safety**

For Decision

1.0 Introduction and Background

1.1 At the December 2013 meeting of this Board Kent County Council (KCC) reported the receipt of a petition and ePetition regarding Broadstairs Schools Road Safety. The petitions which were signed by a combined total of 1517 people requested *“We the undersigned petition the council to restrict the speed along routes to Broadstairs schools to 20mph and actively enforce this through creation of safer crossing points, clearer signage and road markings, and more parking restrictions outside schools”*.

2.0 The Current Situation

2.1 A meeting took place on Friday 6th December 2013. The meeting was attended by David Brazier (Cabinet Member for Transport & Environment), Laura Sandys MP, Andy Corcoran (KCC Traffic Schemes & Member Highway Fund Manager), Annette Bonner (KCC School Travel Planner), Councillors and representatives from the local schools. The schools presented their concerns for road safety and the problems they are experiencing. Positive discussions followed with the agreement that representatives from the schools would work with KCC officers to further explore their concerns and investigate the extent of the perceived problems to identify suitable solutions.

2.2 Through KCC’s Annual Casualty Reduction Programme, crash data for the last 3 year period (to 30/09/13) has been analysed for the roads leading to and surrounding the local Broadstairs schools. A small cluster of three child pedestrian crashes, two categorised as slight and one serious has been identified on A255 Broadstairs Road outside Charles Dickens Secondary School. KCC are proposing to implement a pedestrian crossing at this location as part of the 2014/15 Casualty Reduction Programme. This is subject to funding approval and public consultation.

3.0 Next Steps

3.1 To further develop proposals for the Casualty Reduction Measure as outlined in paragraph 2.2 above with a view to delivering a pedestrian crossing in the 2014/15 financial year.

3.2 KCC officers will work with the local schools and the Broadstairs Road Traffic Group to further investigate the issues and identify the extent of the problems. A further meeting has been arranged with the 'working party' on the 28th March 2014 to start this process. If considered necessary following the further investigations the 'working party' will develop solutions as appropriate with a view to identifying highway improvement measures for inclusion in a bid for funding from the 2015/16 Local Transport Plan.

4.0 Recommendation(s)

4.1 To approve the next steps proposed in paragraphs 3.1 & 3.2 above.

Contact Officer:	<i>Kelly Garrett, Traffic Engineer, 01233 614176</i>
Reporting to:	<i>Tim Read, Head of Transportation, 01622 221603</i>

Annex List

NA	
----	--

Background Papers

Title	Details of where to access copy
NA	

Corporate Consultation Undertaken

Finance	NA
Legal	NA
Communications	NA

Cliffsend Traffic Calming Trial Results & Final Scheme Proposals

To: **Thanet Joint Transportation Board – 27th March 2014**

By: **Tim Read – Head of Transportation**

Classification: **Unrestricted**

Ward: **Cliffsend & Pegwell**

Summary: **This report informs the Board of the relative success of the Phase One Trial measures and details the Phase Two final proposals.**

For Decision

1.0 Introduction and Background

1.1 At the last meeting of this Board on 19 December 2013, KCC reported on proposals for Cliffsend Traffic Calming, the Phase One Trial measures and public consultation results. The scheme purpose is to encourage a greater percentage transfer of traffic from the Canterbury Road West & Sandwich Road to the new sections of A299 & A256 (East Kent Access Phase 2) in addition to improving the environmental and social benefits to Cliffsend as a village. Of those who responded to the public consultation 72% were in support of the proposals.

1.2 The Phase One Trial measures have been in operation for four months (since 11/11/13) and included the following:

- A narrowing of the Cliffsend & northern Lord of the Manor roundabout exits to Canterbury Road West
- The installation of a traffic signalled gateway on Canterbury Road West after the Cliffsend roundabout
- A part closure of the northern Lord of the Manor roundabout meaning no exit to Canterbury Road West from Haine Road (all traffic from Haine Road to left turn down to the signalised gyratory).
- The removal of the build out on Canterbury Road West (near Lord of the Manor).
- A review of the signals and lane markings in order to improve flow and operation

2.0 The Conclusions of the Phase One Trial

2.1 The narrowing of the roundabout exits onto Canterbury Road West showed no significant benefit and gathered rubbish. They were removed during the trial and have been omitted from the overall scheme proposals.

2.2 The signalised gateway on Canterbury Road West has proved successful in reducing traffic volume (see Table 1 below). Concerns were raised initially that the signals were not favouring traffic leaving the village. Alterations were subsequently made to the signals to reduce the green time for traffic entering the village. It was not possible for the signals to rest on green for traffic leaving the village as a safety assessment considered it unsafe in terms of encouraging higher approach speeds.

- 2.3 The partial closure of the northern Lord of the Manor roundabout has proved successful in reducing traffic volume on Canterbury Road West (see Table 1 below). Concerns were raised over the initial queue on Haine Road as a result of all traffic from Haine Road having to turn left to the signalised gyratory. Alterations were subsequently made to the timings of the signals to improve their operation and reduce queues on Haine Road. Observations show this has been successful and has not resulted in unacceptable delay at the gyratory.
- 2.4 Alterations were made to the lane markings at the signalised gyratory during the trial to improve traffic flow and address lane confusion issues.
- 2.5 Table 1: Traffic Monitoring Summary for Canterbury Road West

Average Daily Flow	Before EKA2 Feb/ Mar 2012	After EKA2 Nov 2012	During Trial Feb/ Mar 2014
CRW East Site Near Windsor Road	20,312	10,349 (49% reduction)	5,297 (74% reduction)
CRW West Site Near Jentex	19,576	9,830 (50% reduction)	5,016 74% reduction)
Average Speed			
CRW East Site	33 mph	30 mph	33 mph
CRW West Site	34 mph	33 mph	34 mph

- 2.6 The results of the traffic survey show that the Phase One Trial measures have been successful in further reducing traffic volume on the Canterbury Road West. Vehicle speeds have remained relatively static. The Phase Two measures are expected to reduce vehicle speeds.

3. The Phase Two Proposals

- 3.1 Following the public consultation & exhibition and the Phase One Trial, proposals have been amended taking into consideration comments received and finalised through the detail design in preparation for construction this spring/ summer. A simplified illustration of the Phase Two proposals can be viewed in Annex 1. The detailed drawing number TH-EXT-0047-101 Rev A is in Annex 2. The proposals include:

Canterbury Road West (CRW)

- The making permanent of the signalised gateway;
- The making permanent of the partial closure of the northern Lord of the Manor roundabout;
- White hatching down the centre of carriageway;
- New/ widened footways on south side of CRW between Sea View Road and Cliff View Road;
- The relocation of the Westwood bound bus stop out of the lay-by leaving the lay-by available for general parking;
- The removal of the 'Clearway order' on CRW to allow on street parking;
- The addition of village gateway features to the existing build-out to the east of the village;
- Alterations to the existing speed limits making the section fronted by properties 30mph and the remaining stretches either side 40mph.

Sandwich Road

- The installation of a signalised gateway near the petrol filling station;
- A raised table with zebra crossing near Foads Lane;
- A raised table at the junction with Cliffs End Grove;
- A mini roundabout at the junctions with Meverall Avenue & Cliffs End Road;
- The relocation of the Sandwich bound bus stop out of the lay-by leaving the lay-by available for general parking;
- The removal of the existing build-out near Chalk Hill;
- The addition of a village gateway feature to the east of the village;
- Alterations to the existing speed limits making the section fronted by properties 30mph with a 40mph buffer zone from the new signalised gateway for a distance of approximately 300 metres.

3.2 Larger copies of drawing number TH-EXT-0047-101 Rev A will be available for inspection at the March meeting of this Board.

4.0 Finance

4.1 The combined cost of the Phase One and Phase Two works is approximately £250,000. This represents less than half a percent of the total build cost of the East Kent Access Phase 2 and is budgeted for within the overall scheme funding.

5.0 Recommendation(s)

5.1 Approve drawing number TH-EXT-0047-101 Rev A in Annex 2 for construction in spring/ summer 2014.

Contact Officer:	<i>Kelly Garrett, Traffic Engineer (01233 614176)</i>
Reporting to:	<i>Tim Read, Head of Transportation (01622 221603)</i>

Annex List

<i>Annex 1</i>	<i>Phase Two Proposals</i>
<i>Annex 2</i>	<i>Drawing number TH-EXT-0047-101 Rev A</i>

Background Papers

Title	Details of where to access copy
<i>None</i>	

This page is intentionally left blank

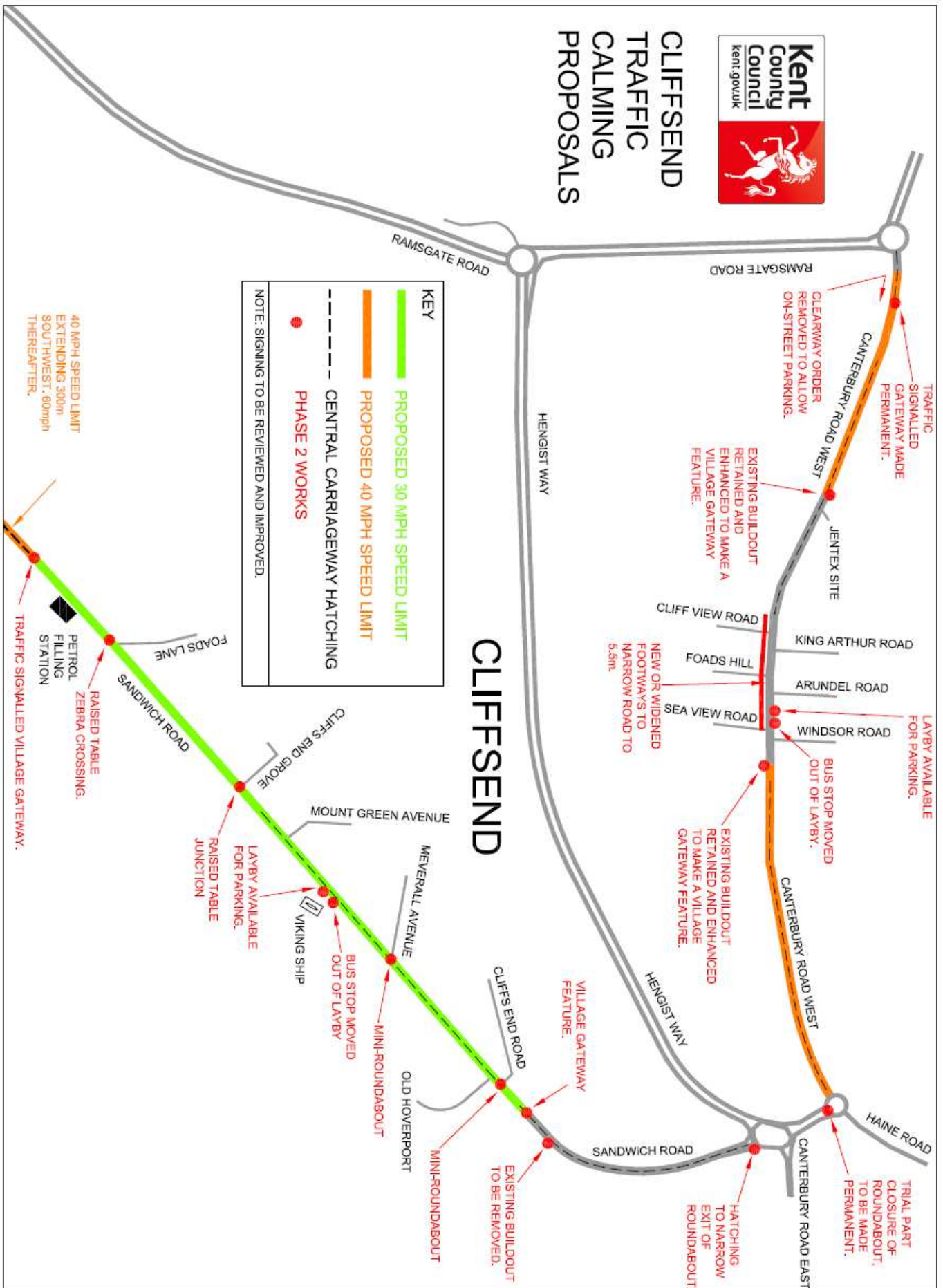

This page is intentionally left blank

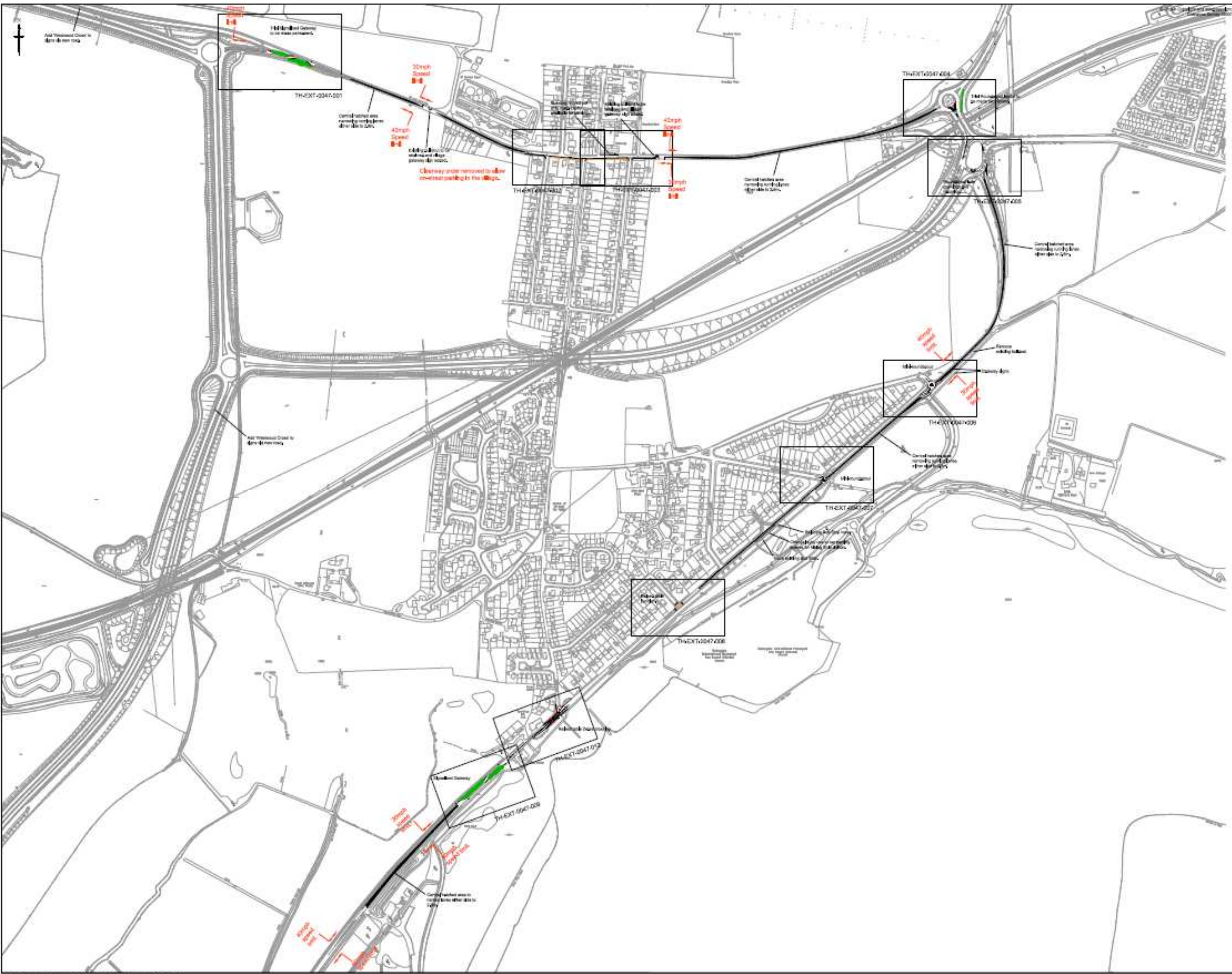

TH-EXT-0047-101 A

									
Kent County Council Active Travel Unit Transport Planning Transport Services									
CLIFFSEND TRAFFIC CALMING SCHEME									
PHASE 2 OVERALL LAYOUT & LOCATIONS OF AD PLANS									
FOR CONSULTATION									
1:2500 A3									
TH-EXT-0047-101									
									A

This page is intentionally left blank

NORTHUMBERLAND AVENUE ZEBRA CROSSING – Member Highway Fund Scheme RESULTS OF CONSULTATION

To: **Thanet Joint Transportation Board, 27th March 2014**

Main Portfolio Area: **KCC – Enterprise and Environment**

By: **Director of Highways and Transportation, Kent County Council**

Classification: **Unrestricted**

Ward: **Cliftonville East** Division: **Margate and Cliftonville**

Summary: **The report summarises the results of the public consultation for a new pedestrian crossing and associated footway widening in Northumberland Avenue, Margate.**

For Decision

1.0 Introduction and Background

- 1.1 Kent County Council (KCC), is proposing the introduction of a new zebra crossing in Northumberland Avenue, Margate.
- 1.2 Staff and pupils from the nearby school have requested a new crossing facility to assist pedestrians when crossing Northumberland Road, in particular for children and parents when crossing to reach Cliftonville Primary School. The request was submitted in the form of a petition in July 2013, the document contained approximately 420 signatures. A copy of the petition can be seen upon request.
- 1.3 The principal scheme aim is to improve pedestrian safety when crossing Northumberland Avenue, and encourage walking and cycling in the area. The scheme also aims to lower vehicle speeds in the area which has been raised as a concern by residents, by way of narrowing the existing carriageway.
- 1.4 A crash analysis was carried out in Northumberland Avenue from its junction with Northdown Road to its junction with Northdown Park Road (a distance of approximately 350 metres) to ascertain if a crash record is present. In the last three years six slight injury crashes were reported. Five were located at the junction of Northdown Road and one at the junction with Northdown Park Road, no crashes were recorded within 100 metres the proposed crossing area. There was no discernible pattern based on the results of the crash analysis.
- 1.5 To safely install a new pedestrian crossing in the vicinity of the school some on street parking will need to be removed. The proposed site has been deemed the most suitable location for a crossing, but will require the removal of all on street parking spaces between nos. 77 to 81 and part of 75 Northumberland Avenue. After taking into account that each of these properties has an existing private driveway / access the proposal as shown would remove approximately 6 on street parking spaces.

2.0 Summary of consultation response

- 2.1 A scheme proposal was prepared and put forward for public consultation. The scheme proposal may be seen in Annex 1.

- 2.2 The consultation period ran for just over 5 weeks (taking into account the Christmas period), from 28th November 2013 to 6th January 2014. Information leaflets and plans were distributed to 35 immediately affected residents and businesses and 4 notification posters were placed along Northumberland Avenue.
- 2.3 All of the consultation information was made available on the www.kent.gov.uk website, which included the opportunity to comment via email, post or telephone. Other consultees directly contacted included Thanet District Council, the local District and County Councillors, the emergency services and bus companies.
- 2.4 Consultees were asked whether they supported the proposals, and to provide any additional comments/thoughts that were relevant to the scheme. A summary of the responses received can be seen in Annex 2. Detailed copies of the consultation responses can be viewed upon request. The results were as follows:-

Do you support the proposed zebra crossing in Northumberland Avenue?	
Yes	No
37.5% (3)	62.5% (5)

- 2.5 The Head Teacher of Cliftonville Primary School has provided strong support for the scheme as has both local County Council Members, and the school crossing patrol. The Head Teacher and other staff at the school have advised that the new crossing is not proposed to replace the existing crossing patrol, but provide a safer environment and location for the patrol to operate. All three residents directly fronting the proposed site have objected to the proposals outlined. Their reasons for objection are outlined in Annex 2.

3.0 Financial

- 3.1 The scheme will cost £22,160 to implement. This will include high friction road surfacing on approach to the crossing, and the costs associated with widening the footway on the eastern side of the road. Kent County Councillors William Scobie and Mo Elenor have chosen to use some of their Member Highway Fund allocation to progress and construct this scheme. In addition, the governors at Cliftonville Primary School have also pledged to make a £1,000 contribution towards the project.

4.0 Recommendation

- 4.1 All funding is to be delivered by the local County Council Members and the nearby school. Based on the petition for a crossing, and amendments made after the consultation process it is proposed that the scheme proceed as outlined.

Future Meeting if applicable: N/A	Date: 27/03/2014
-----------------------------------	------------------

Contact Officer:	<i>Ryan Shiel, Traffic Engineer 08458 247800</i>
Reporting to:	<i>Andy Corcoran, Traffic Schemes and Member Highway Fund Manager</i>

Annex List

<i>Annex 1</i>	<i>Scheme Proposal / Plan</i>
<i>Annex 2</i>	<i>Consultation Responses</i>

**NORTHUMBERLAND AVENUE ZEBRA
CROSSING SCHEME – Member Highway Fund Scheme
Annex 1 – Scheme Proposal / Plan**

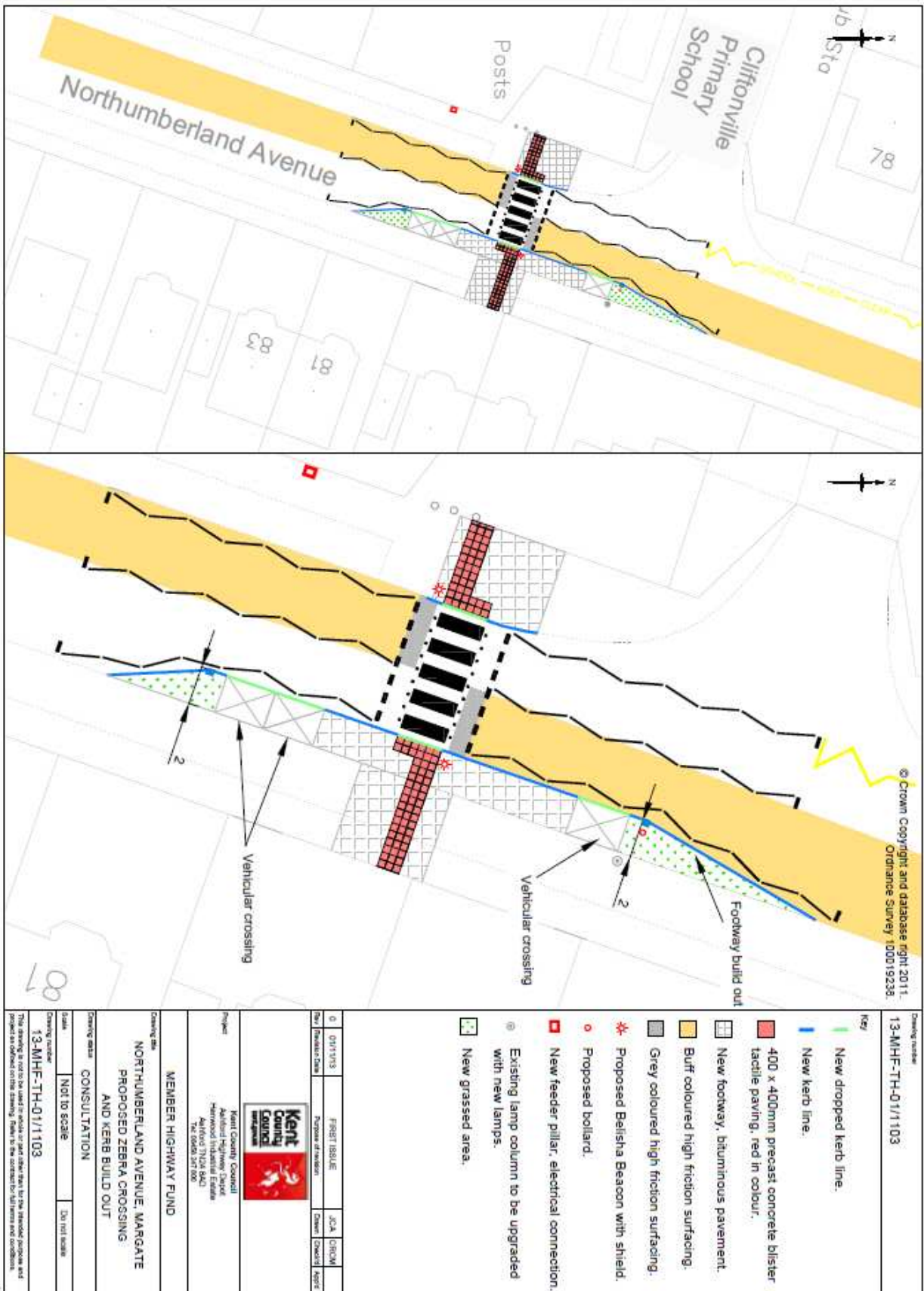

**NORTHUMBERLAND AVENUE ZEBRA
CROSSING SCHEME – Member Highway Fund Scheme
Annex 2 – Consultation Responses**

Item	Comment received	KCC response
1.	The installation of a new zebra crossing in front of the residential properties is an over the top solution to the problem which will penalise residents in the fact that they will not be able to park vehicles outside their homes.	The carriageway is extremely wide at this point, over 8 metres in width. The widened footway is an essential element of this scheme to ensure that visibility for pedestrians using the crossing is sufficient, and to make sure parked cars do not obscure vision to drivers on approach to the proposed crossing. As with any crossing scheme the main aim is to help pedestrians safely cross and remain in the vehicular carriageway for as little time as possible, narrowing the carriageway is an effective way to reduce the risk.
2.	To ease the pressures in Northumberland Avenue a speed restriction of 20 mph should be introduced and to have traffic calming measures installed in the street to help alleviate some of the risks.	Traffic calming is beyond the scope of this scheme.
3.	A lot of the problems are caused by parent's dangerous driving habits and school staff, parking on the road instead of the car park, leaving less space for the sensible parents to drop their children off safely.	Comment noted. We will raise this issue with Cliftonville Primary School and ask that they take appropriate action.
4.	Introduction of two belisha beacons will add further unnecessary light pollution to this area. How effective will the shields be, as the ones at the top of the road seem to have disappeared? It is also not clear whether the beacons are proposed to have illuminated poles.	The proposed scheme does not include illuminated beacon poles, just the orange beacon globes. The shields will be black metal covers which will cover the light from directly shining into nearby properties. KCC Street lighting has now been made aware of the missing shields in Northdown Park Road.
5.	What type of surfacing is proposed, and will this lead to an increase in road noise?	Application of high friction surfacing is a standard procedure for new pedestrian crossings. The material is used frequently in urban areas, and we have not previously received any complaints about additional road noise.
6.	The zig zag lines extend further than the built out footway. Could this be reduced to maintain some on street parking on the eastern side of Northumberland Avenue?	Comment noted. The scheme proposal will be amended to ensure that the zig – zag lines on the exit and approach of the eastern side of the road are reduced by 2 metres.
7.	The safety of children crossing this road at peak school starting and finishing times is of paramount importance and there is a risk to this if some form of action is not taken especially with plans to expand the school further in the immediate future.	Comment noted.
8.	The school busy period is for about an hour in the morning and maximum two hours in the afternoon Monday to Friday during term time. The rest of the time the street is fairly calm and residents should be allowed to park outside their properties during these periods.	To safely install a pedestrian crossing in Northumberland Avenue, some on street parking provision will need to be removed. There are minimum parking restrictions associated with new crossings, to maintain adequate visibility. Please see KCC response to item 1.

To: Thanet Joint Transportation Board
By: KCC Highways and Transportation
Date: 27th March 2014
Subject: Highway Works Programme 2014/15

Classification: Information Only

Summary: This report updates Members on the identified schemes approved for construction in 2013/14

1. Introduction

This report provides an update and summarises schemes that have been programmed for delivery in 2014/15

Footway and Carriageway Improvement Schemes – see Appendix A

Drainage Repairs & Improvements – see Appendix B

Street Lighting – see Appendix C

Developer Funded Works – see Appendix D

Transportation and Safety Schemes – see Appendix E

Public Rights of Way – see Appendix F

Member Highway Fund – see Appendix G

Conclusion

1. This report is for Members information.

Contact Officers:

The following contact officers can be contacted on **03000 418181**

Toby Howe	Highway Manager (East)
Paul Valek	Thanet District Manager
Neil Tree	Carriageway Surface Treatment
Russell Boorman	Carriageway Machine Surfacing
Wendy Boustead	Footway Improvement Team Leader
Katie Lewis	Drainage Manager
Sue Kinsella	Street Lighting Manager
Toby Butler	Intelligent Transport Systems Manager
Richard Heaps	Transportation and Safety Schemes
Melvyn Twycross	PROW
Tony Ambrose	Structures Manager
Bob White	Developer Funded Works

Appendix A – Footway and Carriageway Improvement Schemes

The delivery of these schemes is weather dependent; should it prove not possible to carry out these works on the planned dates, new dates will be arranged and the residents will be informed by a letter drop to their homes.

Surface Dressing – Contact Officer Mr Neil Tree			
Road Name	Parish	Extent of Works	Current Status
Bedlam Court Lane	Minster	Whole Length	Programmed to start Spring/Summer 2014
Foxborough Lane	Minster	Whole Length	Programmed to start Spring/Summer 2014
Joss Gap Road	Broadstairs	Whole Length	Programmed to start Spring/Summer 2014
Whiteness Road	Broadstairs	Whole Length	Programmed to start Spring/Summer 2014
The Lanes	Minster	Whole Length	Programmed to start Spring/Summer 2014
Grinsell Hill	Minster	Whole Length	Programmed to start Spring/Summer 2014
Cottington Road	Minster	From its junction with Thorne Hill to A299 slip road	Programmed to start Spring/Summer 2014
Convent Road	Broadstairs and St Peters	From its junction with George Hill Road to its junction with Joss Gap Road	Programmed to start Spring/Summer 2014
Hereson Road	Broadstairs and St Peters	From its junction with Sycamore Grange to its junction with Ramsgate Road	Programmed to start Spring/Summer 2014
A255 Ramsgate Road	Broadstairs and St Peters	From its junction with Gladstone Road to Ramsgate Road roundabout	Programmed to start Spring/Summer 2014

Micro Asphalt Schemes – Contact Officer Mr Neil Tree

Road Name	Parish	Extent of Works	Current Status
Radley Close	Broadstairs	Whole length including junction with Tina Gardens	Programmed to start Spring/Summer 2014
Dumpton Lane	Ramsgate	From its junction with the railway bridge to its junction with College Road	Programmed to start Spring/Summer 2014
Linden Avenue & Dalmaney Close	Broadstairs	Whole length	Programmed to start Spring/Summer 2014
Pysons Road	Ramsgate and Broadstairs	From its junction with Margate Road to its junction with Hopes Lane	Programmed to start Spring/Summer 2014
Vicarage Street	Broadstairs	Whole length	Programmed to start Spring/Summer 2014
Church Street	Broadstairs	Whole length	Programmed to start Spring/Summer 2014
High Street St Peters	Broadstairs	Whole length	Programmed to start Spring/Summer 2014
Hopeville Avenue	Broadstairs	Whole length	Programmed to start Spring/Summer 2014
Albion Road	Birchington	Whole length	Programmed to start Spring/Summer 2014
Roxburgh Road	Westgate	Whole length	Programmed to start Spring/Summer 2014
Sundew Grove	Ramsgate	Whole length	Programmed to start Spring/Summer 2014
Hollicondane Road	Ramsgate	Whole length	Programmed to start Spring/Summer 2014

Machine Resurfacing – Contact Officer Mr Russell Boorman			
Road Name	Parish	Extent of Works	Current Status
A256 Westwood Road/Northwood Road Roundabout	Broadstairs	Eastbound and westbound approaches only	Programmed to start Summer/Autumn 2014
A28 Canterbury Road	St Nicholas-at-Wade	Southbound approach to roundabout	Programmed to start Summer/Autumn 2014
A255 High Street	Broadstairs	Both approaches to the pedestrian crossing near Carlton Avenue	Programmed to start Summer/Autumn 2014
Station Road/St Mildreds Road	Westgate	Westgate Bay Avenue to Railway bridge/St Mildreds Road to Roxburgh Road	Programmed to start Summer/Autumn 2014
Footway Improvement - Contact Officer Mrs Wendy Boustead			
Road Name	Parish	Extent and Description of Works	Current Status
Callis Court Road	Broadstairs and St Peters	From its junction with Grange Road to its junction with Reading Street. This scheme is still in the design stages. Construction still to be determined.	Programmed to start Summer/Autumn 2014

Appendix B – Drainage Repairs & Improvements

Drainage Repairs & Improvements - Contact Officer Katie Lewis			
Road Name	Parish	Description of Works	Current Status
St Peters Road	Broadstairs	Installation of soakaways in verge adjacent to the A256	Works Completed 12/09/13
Upper Dane Road	Margate	Installation of new Drainage system and Soakaways	Works Completed 29/10/13
Monkton Road	Minster	Installation of new drainage system	Works Completed 22/11/13
Manston Road	Manston	Drainage improvement works	Works Completed 15/11/13

Appendix C – Street Lighting

The following columns are being replaced as they have been identified as high risk during structural testing. Work is programmed to be completed by the end of July 2014.

Street Lighting Column Replacement – Contact Officer Sue Kinsella			
Road Name	Column Ref	Location	Status
London Road	HLBV006	OPP ADJ 44 LHS	Complete
London Road	HLBV021	O/S 18	Complete
London Road	HLBV023	Opp 85	Complete
London Road	HLBV026	O/S 50	Complete
London Road	HLBV027	Opp 81	Complete
London Road	HLBV031	O/S 107	Complete
Dalby Square	HDAC008	OPP ADJ 25	Complete
Granville Avenue	HGBG003	O/S 8	Complete
Wentworth Drive	HWBJ002	O/S 5	Complete
Vine Close	HVAW004	O/S 25	Complete
Chichester Road	HCCZ007	O/S 22	Complete
Ramsgate Road	HCAW014	J/W CANTERBURY ROAD R-A-B	Complete
Coxes Avenue	HCGB002	O/S 15	Complete
Artillery Road	HACM004	Opp 27	Complete
Sandwich Road	HSAL066	OPP JET GARAGE	Proposed Improvement scheme
Kirkstone Avenue	HKBD003	O/S 12/14	Complete
Danesmead Terrace	HDAX001	O/S 1	Complete
Friends Avenue	HFBR010	O/S 34	Complete
Bradley Road	HBCH502	O/S 46	Complete
West Dumpton Lane	HWBO028	OPP J/W SHIRLEY AVENUE	Complete
Zion Place	HZAA	J/W Northdown Road	Complete
Cottage Road	HCFV001	S/O EAST CLIFF HOUSE	Awaiting base plate / socket and reprogramming
Nixon Avenue	HNAZ501	O/S 24	Complete
Westfield Road	HWCB501	OPP 1	Complete
Laleham Road	HLAE001	S/O 103 NORTHDOWN PARK ROAD	Complete but still awaiting old concrete column to be removed
Laleham Road	HLAE002	OPP 3	Complete
Laleham Road	HLAE003	O/S 9	Complete
Laleham Road	HLAE004	O/S 19	Complete
Laleham Road	HLAE006	O/S 31	Complete
Laleham Road	HLAE008	O/S 45/47	Complete
Laleham Road	HLAE010	O/S 61	Complete
Laleham Road	HLAE011	O/S 56/58	Complete
Byron Avenue	HUBI002	OPP R/O 122 BYRON AVENUE	Complete

Hawley Street	HHBG001	OPP 2/4	Job reissued paperwork missing will need to be done OOH with 4 way lights
Hartsdown Road	HHEB503	OPP ALL SAINTS CHURCH MEMORIAL	Post and light unit up but No sign face or UKPN Service
King Street	HKAS012	OPP GARAGE	Complete
Station Road	HSFW005	O/S FLAG & WHISTLE PH	Complete
High Street	HHBX001	J/W CHARLOTTE STREET	Awaiting UKPN approval
High Street	HHBX002	O/S 14/16 SHOP	Awaiting UKPN approval
High Street	HHBX003	O/S YE OLD CROWN P/H	Awaiting UKPN approval
High Street	HHBX004	O/S 36 SHOP	Complete
High Street	HHBX005	O/S 35 SHOP	Complete
High Street	HHBX006	OPP J/W QUEENS ROAD	Complete
High Street	HHBX007	O/S 53 SHOP	Complete
High Street	HHBX008	O/S 67 SHOP	Complete
High Street	HHBX009	OPP 82 SHOP	Complete
High Street	HHBX010	OPP 88 SHOP	Complete
High Street	HHBX011	OPP J/W VERE ROAD	Complete
High Street	HHBX012	O/S 104	Complete
High Street	HHBX013	O/S 130 SHOP	Complete
High Street	HHBX014	O/S 89 SHOP	Complete
High Street	HHBX015	O/S 107	Complete
High Street	HHBX016	J/W STANLEY PLACE	Complete
High Street	HHBX017	O/S 162 SHOP	Complete
High Street	HHBX018	OPP J/W CLARENDON ROAD	Complete
Bromstone Road	HBDB006	O/S 19	Complete
Bromstone Road	HBDB008	O/S 22	Complete
Bromstone Road	HBDB009	O/S 26	Complete
Bromstone Road	HBDB013	O/S 38	Complete
Bromstone Road	HBDB015	O/S 40	Complete
Bromstone Road	HBDB016	OPP 48	Complete
Bromstone Road	HBDB025	O/S 73/75	Complete
Royal Esplanade	HRBR030	ADJ 50 RHS	Complete
St Peters Road	HSFG039	1ST BTW 145 AND J/W DANE COURT ROAD	Complete
High Street	HHEG007	O/S 72/74	Complete
Ramsgate Road	HRAD018	OPP 64	Complete
Eastchurch Road	HEAD042	O/S 101	Complete
Hugin Avenue	HHDJ010	OPP 54/56	Complete
Turner Street	HTCT003	O/S 8/10	Complete
Abbey Grove	HAAB002	O/S 6	Complete
Abbey Grove	HAAB003	O/S 14	Complete
Empire Terrace	HEBM001	S/O 1 NASH ROAD	Complete

Queens Road	HQAN009	OPP J/W KING EDWARD AVENUE	Job was cancelled and Re raised Replacement by the end of May
Dane Court Road	HDAH003	3RD FROM BROADSTAIRS ROAD R-A-B	Complete
Dane Court Road	HDAH004	4TH FROM BROADSTAIRS ROAD R-A-B	Complete
Dane Court Road	HDAH006	6TH FROM BROADSTAIRS ROAD R-A-B	Complete
Gordon Square	HGAY002	OPP 2/3	Complete
Edge End Road	HEAM505	J/W VALE ROAD	Complete
Trinity hill Car Park	HTDK001	CENTRE OF CAR PARK	Complete
Thanet Road	HTAH002	SIDE OF No12	Complete
Newington Road	HNAV518	O/S 90	Complete
Newington Road	HNAV519	OPP 92	Complete
Rydal Avenue	HRCA002	O/S 6	Complete
Canterbury Road East	HCAT518	OPP J/W GRASMERE AVENUE	Complete
Dumpton Park Road	HDCG057	O/S 77	Complete
Beacon Road	HBEG022	OPP 160	Complete
Park Avenue	HPAL032	O/S 116	Complete
The Ridgeway	HTBM018	O/S 64/66	Complete
The Ridgeway	HTBM015	O/S 48	Complete
John Street	HJAD001	J/W YORK STREET	Problems with foundations, it has been agreed with the owner of the Bijou Hotel that a wall mounted unit can be used. Replacement by end of April
Colburn Road	HCEQ006	O/S 8	Complete
Foads Lane	HFAY506	OPP S/O 6 GREYSTONES ROAD	Complete
Foads Lane	HFAY502	J/W SANDWICH ROAD	Complete
Rodney Street.	HRBB003		Problems with parking and access Road Closure Required
		o/s23	
Canterbury Road West	HCAQ030	O/S 7	Complete
Canterbury Road West	HCAQ036	2nd BTW 22 & 40	Complete
Canterbury Road West	HCAQ037	3rd BTW 22 & 40	Complete
Canterbury Road West	HCAQ040	O/S 46	Complete
Canterbury Road	HCIE229	O/S 385	Complete
Canterbury Road	HCIE231	OPP CAFÉ LHS	Complete
Canterbury Road	HCIE244	OPP PACE PETROL GARAGE	Complete
Canterbury Road	HCAV006	OPP SIESTA	Complete
Canterbury Road	HCIH032	OPP 129	Complete

Canterbury Road	HCIH036	1st ON BRIDGE	Complete
Canterbury Road	HCIH037	2nd ON BRIDGE	Complete
Canterbury Road	HCIH038	3rd ON BRIDGE	Complete
Canterbury Road	HCIH039	4th ON BRIDGE	Complete
Canterbury Road	HCIH073	O/S 186	Complete
Canterbury Road	HCIH086	O/S 295	Replacement by end of May
Canterbury Road	HCIH088	O/S 240	Complete
Canterbury Road	HCIG172	OPP J/W EDWARD DRIVE	Complete
Canterbury Road	HCIG179	OPP 137 LHS	Complete
Canterbury Road	HCIG184	OPP S/O 1/3 CHARLESWORTH DRIVE	Complete
Canterbury Road	HCIG193	OPP ADJ 191 LHS	Complete
Green Lane	HGBJ008	OPP R/O 63 ST MICHAELS AVENUE	Complete
Green Lane	HGBJ010	J/W ST MICHAELS AVENUE RHS	Complete
Green Lane	HGBJ018	R/O 7 ST MICHAELS AVENUE LHS	Complete
Godwin Road	HGAR014	ADJ 1 GODWIN BUNGALOWS	Complete
Ethelbert Road	HECJ001	R/O 11	Complete
Ethelbert Road	HECJ003	R/O 39	Complete
Ethelbert Road	HECJ004	R/O 53	Complete
Eastern Esplanade	HEAF016	J/W THIRD AVENUE RHS	Complete
Eastern Esplanade	HEAF017	ADJ J/W THIRD AVENUE RHS	Complete
Eastern Esplanade	HEAF018	J/W SURREY ROAD RHS	Complete
Eastern Esplanade	HEAF019	OPP J/W SURREY ROAD	Complete
Eastern Esplanade	HEAF021	J/W CORNWALL GARDENS RHS	Complete
Eastern Esplanade	HEAF022	O/S 14	Complete
Eastern Esplanade	HEAF023	O/S ST ANNES CHURCH	Complete
Ellington Place	HEBD001	J/W HIGH STREET	Complete
Buckingham Road	HUBK002	R/O 36 BUCKINGHAM ROAD	Complete
Beacon Roa	HBEG011	O/S 58	Complete
Canterbury Road	HCIG172	OPP J/W EDWARD DRIVE	Complete
Canterbury Road	HCIG179	OPP 137 LHS	Complete
Canterbury Road	HCIG184	OPP S/O 1/3 CHARLESWORTH DRIVE	Complete
Canterbury Road	HCIG193	OPP ADJ 191 LHS	Complete
Albion Road	HAAY009	O/S 48	Complete

Appendix D – Developer Funded Works

Developer Funded Works (Section 278 Works) Contact Officer Glenn Holliday			
Road Name	Parish	Description of Works	Current Status
Westwood	Ramsgate	New Neighbouring Road network.	Works are 99% complete. All carriageways and footways are complete. 4 of the 5 toucan Crossings have been commissioned. The remaining toucan crossing will be commissioned mid March at which time the works will be complete.
Ramsgate Road	Broadstairs	Hereson School. New Access and zebra crossing on Ramsgate Road and New access of Merrivale Heights serving residential development.	Technical approval granted and section 278 agreement signed. All works are complete other than the final resurfacing to Ramsgate Rd, this will commence once agreement is finalised with the lane rental team.
Margate Road Westwood	Broadstairs	New access serving Proposed Marstons Pub and restaurant	Technical Approval granted, awaiting Completion of S278 agreement.
Margate Sea Defence	Margate	Highway Works associated with flood defence scheme.	Works complete, scheme on Maintenance
The Centre, Newington	Ramsgate	Highway Works associated with regeneration scheme.	S278 agreement signed and works ongoing
Northdown Road	Margate	Capital House Section 38 residential development with new access onto Northdown Road.	Works Complete
Vere Road	Broadstairs	New access road serving New coach park and Residential development	Technical Assessment has commenced and legal Instructions have been issued for the Section 38 Agreement.
New Sainsbury's Store Margate Road/ New Haine Road	Broadstairs	New link road between New Haine Road and Margate Road including associated works to the roundabouts on Margate Road and New Haine Road.	Technical Assessment ongoing and legal agreements being prepared. Developer intends to start work in April 2014

Appendix E – Transportation and safety schemes

The Traffic Schemes Team is implementing a number of schemes within the Thanet District, in order to meet Kent County Council's strategic targets (for example, addressing traffic congestion, or improving road safety). New Casualty Reduction Measures (CRMs) have been identified to address a known history of personal injury crashes; for Members' information, these are specifically highlighted with an asterisk:

Local Transport Plan Funded Schemes- Contact Officer Kelly Garrett			
Road Name	Parish	Description of Works	Current Status
Acol Hill/ Manston Road	Birchington	Proposed HFS to be installed on the B2048 (Acol Hill), direction sign to Manston / Two Chimneys to be erected	Works complete
Manston Road	Birchington	Proposed SLOW markings to be added next to the existing bend warning signs	Works complete
Minster Road/ Shottendane Road	Westgate on Sea	Proposed HFS to be installed on Shottendane Road at the junction, SLOW markings to be added next to existing junction warning signs. Ops to refresh the existing giveway markings on Minster Road and move the existing sign plates	Works complete
Northdown Road/ Godwin Road*	Cliftonville	Zebra Crossing to be installed on the existing build-out between Cash Maker and Cooke & Co estate agents	Works complete
Ramsgate Road/ Granville Road*	Broadstairs	Arrange for a pedestrian and vehicle turning count to be carried out, in addition arrange for a speed survey to be undertaken	No crash pattern obvious. No further crashes this year so scheme deferred until 2014/2015
Fort Road/ Love Lane/ King Street/ Hawley Street	Margate	Pedestrian route improvements to Turner Contemporary. Zebra crossing to be installed across Hawley Street. Footway to be widened on King Street. Localised kerb works/ build outs.	Works Programmed for March 2014.

Park Lane/ Brunswick Road*	Birchington	One mains powered interactive sign to be installed with additional slow markings. Existing 'side road ahead' sign to be moved to accommodate this. Speed limit terminal signs to be moved and TRO revised	Works complete except for the marking of the red high friction patch and 30mph roundel which will be completed when weather permits.
Canterbury Road West and Sandwich Road	Cliffsend	Proposed traffic calming measures aimed at transferring more through traffic onto new A299 (Cliffsend by-pass) and slowing remaining traffic on Canterbury Road West and Sandwich Road. Phase 1: Three month trial of signals on Canterbury Road West and part closure on northern Lord of the Manor roundabout. Phase 2: Subject to consultation results and success of 3 month trial, phase 1 to be made permanent and other traffic calming measures implemented.	Public consultation on new proposals for Canterbury Road West and Sandwich Road due to end on 29/12/13. Phase 1 Trial works completed 11 th November 2013. Trial to run Nov 13 to Feb 14. Phase 2 Works planned for spring 2014.
Broadley Road/ St Peters Road	Margate	Have secured funding to install a toucan crossing at the junction of Broadley Road and St Peters Road	Works under construction. Completion expected March 14.
Thanet QBP - public transport infrastructure	District wide	Bus stop infrastructure improvements at pair of bus stops on Cecil Street, Margate (opposite & adjacent to Thanet DC offices). To include footway widening at stop opposite Thanet DC offices.	Works planned for March/ April 2014.
A255 Broadstairs Road *	Broadstairs	Pedestrian Crossing outside Charles Dickens Secondary School	Works planned for 2014/15
A28 Canterbury Road *	St Nicholas-at-Wade/ Birchington	Phase 1: On section between St Nicholas roundabout and Brooksend: Signing/ lining/ road studs/ reduced speed limit on dual carriageway/ mobile safety camera at Brooksend.	Works planned for 2014/15

Appendix F – Public Rights Of Way

Public Rights of Way – Contact Officer Melvyn Twycross			
Path No	Parish	Description of Works	Current Status
NO further updates			

Appendix G – Member Highway Fund

All Members in the Thanet District have now submitted applications, but many are still at the design or approval stage. The following schemes are those which have been approved by both the relevant Member and have been approved by John Burr, and is up to date as of 28th February 2014.

More detail on the schemes below can be found within the individual Member update sheets which are available for each Member to access online.

Alan Terry and Zita Wiltshire (combined) – Broadstairs and Sir Moses Montefiore

Scheme	Cost	Status
Callis Court Road, Broadstairs – Resurfacing of public footway from Grange Road junction to Reading Street junction and installation of new SLOW markings and road narrowing signs.	£9,600 contribution	Awaiting programme date
Broadstairs Road roundabout – Summer and winter planting of roundabout and general maintenance of site for one full year.	£6300	Summer planting due in April 2014

Alan Terry – Broadstairs and Sir Moses Montefiore

Scheme	Cost	Status
Westwood Road, Broadstairs – installation of new bus shelter at the St. Peters bound bus stop opposite Asda. Bus shelter will include internal light and advertising boards.	£10,240	Awaiting programme date

Zita Wiltshire – Broadstairs and Sir Moses Montefiore

Scheme	Cost	Status
Victoria Parade, Broadstairs – installation of pedestrianized zone with new block paving surface.	£12,710	Consultation stage. Ends w/c 17/3/14

Jeffrey Elenor – Margate West

Scheme	Cost	Status
St Mildred’s Road and Station Road, Westgate-on-Sea – Planting of 3 new trees, 5 new benches, 2 cycle stands and some new planters throughout the main shopping area of Westgate.	£17,392	Complete
Westgate-on-Sea – New winter safety equipment and salt bin for residents of Westgate Residents Association.	£415	Complete

Various areas within Margate West division – Contribution to the continued running of the route 32 bus service on Sundays and bank holidays, until the end of March 2014.	£1,760	Complete
---	--------	----------

Martyn Heale and Trevor Shonk – Ramsgate

Scheme	Cost	Status
Wellington crescent, Ramsgate – Installation of new pedestrian refuge island	£11,600	Complete, awaiting remedials
St Luke’s Avenue, Ramsgate – New traffic calming scheme involving 5 series of traffic cushions.	£12,620	Awaiting programme date. Road closure April 2014.
Margate Road, Ramsgate – Installation of a zebra crossing near the junction with Coxes Lane.	£22,020	Consultation stage finished. No objections.

Mo Elenor – Margate and Cliftonville

Scheme	Cost	Status
A254 Ramsgate Road and nearby roads – Improved signage to Margate Crematorium	£2,525	Programmed for late March 2014
Northumberland Avenue, Cliftonville (o/s Primary School) – Installation of new zebra crossing and kerb build out. Scheme to be jointly funded with KCC Member William Scobie.	£10,580	Awaiting decision at JTB
Margate High Street and Cecil Square – Signage improvements in Margate High Street, and new car parks sign in Cecil Square.	£3,665	Complete
Various areas within Margate and Cliftonville division – Contribution to the continued running of the route 32 bus service on Sundays and bank holidays, until the end of March 2014.	£1,480	Complete

Roger Latchford – Birchington and Villages

Scheme	Cost	Status
Hereward Avenue, Birchington – Planting of 8 new trees in the existing grass verge at various locations.	£2,980	Complete
Alpha Road, Birchington – Installation of new zebra crossing outside Birchington library.	£15,767	Complete
Smugglers Way and various roads, Birchington – New tree planting to replace any plants damaged during the recent storms and bad weather.	£2,503	Works in progress.

William Scobie – Margate and Cliftonville

Scheme	Cost	Status
Northumberland Avenue, Cliftonville (o/s Primary School) – Installation of new zebra crossing and kerb build out. Scheme to be jointly funded with KCC Member Mo Elenor.	£10,580	Awaiting decision at JTB
Lister Road, Drapers Close and various roads around the QEQM hospital – Funding of additional TDC parking enforcement around the QEQM hospital.	£650	Complete
Crundale Way, Margate – Request for traffic survey	£500	Complete
Grotto Hill, Margate – Request for traffic survey	£500	Complete

1.1 Legal Implications

1.1.1 Not applicable.

1.2 Financial and Value for Money Considerations

1.2.1 Not applicable.

1.3 Risk Assessment

1.3.1 Not applicable.

Contact: Paul Valek 03000 418181

This page is intentionally left blank

From: Andrew Loosemore
Head of Highway Operations

To: Thanet Joint Transportation Board

Date: 27th March 2014

Subject: Find and Fix - Weather Damage Repairs 2014

Classification: Unrestricted

Summary:

This report provides details of action being taken by Highways and Transportation to repair the road damage caused by the recent severe weather and flooding.

Recommendation:

Members are asked to note the contents of this report.

1. Introduction

The recent extremely wet weather which has been ongoing since the St. Jude storm in October 2013 which continued through Christmas and January 2014 has led to flooding in many parts of the county. The highway network has suffered damage to the road surface and it's sub-structure with culverts and other drainage systems becoming blocked and silted. Some of the county's main roads have experienced weeks of flooding and many communities have been badly affected by the floods resulting in evacuations for some residents.

Following one of the wettest years recorded and the wettest January on record, an increase in road damage was inevitable. Highways and Transportation have therefore prepared for a Find and Fix repair blitz by developing an in-house process with the term contractor to run a weather damage programme engaging additional support from local sub-contractors.

Local Highway Operations teams will identify priority areas and mark up works that need to be done and these will be passed to the contractor. Additional resources have been put in place and work will be completed as soon as possible and as the weather permits. The continuing heavy rainfall severely hampers works as saturated roads many with standing and running water are unable to receive a permanent repair.

2. Budget

KCC has identified an additional £2.5 million for this work and this will supplement existing funds already allocated for patching works.

The programme of works is on-going and Enterprise, our Highways Maintenance service provider has augmented their own workforce with local contractors. In total five local companies are providing additional teams county wide that are now engaged in and dedicated to delivering the weather damage repair programme.

3. Quality Repairs

We always aim to complete a first-time permanent repair by saw-cutting around the damaged road surface, clearing out the old material, sealing the edges and repairing it with new hot tarmac, which is rolled and compacted to provide a strong level and water-tight finish as it cools. If a road has lots of potholes we may need to complete a larger “patch” in the same way or resurface the whole section of road with specialist machinery to provide a satisfactory long-lasting repair.

The time and care needed to carry out a quality permanent repair often means we need to close a lane or the whole road and this takes time to plan. For emergency potholes and in roads which are saturated or have running water, we may need to make an instant repair by quickly filling the hole without all the preparations described above. We do this to make the road safe to remove the danger and then schedule in a full permanent repair to be carried out as soon as possible thereafter.

It should be noted however, that first time permanent repairs always remain the first choice repair process where it is suitable and practical to do so.

Contact details

Paul Valek – Thanet District Manager
03000 418181

Traffic Management - Parking & Waiting Restrictions – Thanet

To: **Thanet Joint Transportation Board – 27 March 2014**

By: **Civil Enforcement Manager**

Classification: **Unrestricted.**

Ward: **Across the District – Various**

Summary: **The report presents the results of investigations at various locations where parking restrictions have been requested over the last four months.**

For Recommendation:

1. Introduction and Background

- 1.1 Since 2005 the responsibility for parking matters in the Thanet District is split between Kent Highways and Transportation for requests relating to safety and Thanet District for amenity requests. Requests that both councils have received over the past four months have been investigated and those that are considered to be viable are shown with recommendations in annex1.
- 1.2 Making changes to Traffic Regulation Orders is a lengthy and costly process involving changes to legal documents and thorough public consultation. In order to optimise the handling of these changes, the requests are consolidated into an annual review. Objections that are received during the public consultation will be brought back to the Board later in the year for a decision about whether to implement the proposed changes.
- 1.3 The officers' recommendations as to whether each proposal should be implemented are based on the General Provision for Traffic Regulation in the Road the Road Traffic Regulation Act 1984. Within the Act changes are considered to be justified:
- a) where a road safety hazard exists;
 - b) where traffic flow on main roads is impeded;
 - c) where access is seriously obstructed, particularly for emergency vehicles;
 - d) where damage to the highway or to buildings is caused by particular classes of vehicle;
 - e) where serious loss of amenity is caused.
- 1.4 Additionally, as a general rule, parking restrictions are not recommended in remote locations where there is little chance of enforcement. The opportunity has also been taken to review locations where parking restrictions can be removed.

2. Options available

2.1 Members of the Board can:

2.11 Support the officers' recommendations about whether to consult on each of the proposals,

2.12 Make a different recommendation about whether to consult on individual proposals,

2.13 Recommend amendments to any of the proposals to be advertised.

3. Corporate Implications

3.1 Financial

3.1.1 Parking and waiting restrictions are funded, managed and enforced by the Thanet District Council using the decriminalisation budget.

3.1.2 No additional staffing resources are proposed, as the majority of the controls should be self-enforcing.

4.2 Legal

4.2.1 There are no legal implications.

5.3 Corporate

5.3.1 The proposals are intended to improve access, sight lines and the free flow of traffic. This is applicable not only to residential traffic but also to Emergency Service vehicles and stagecoach. If controls are not introduced, having identified a problem and proposed a solution and if an incident were to occur, it is possible that Members could be challenged for a failure to discharge their duty of care.

6.4 Equity and Equalities

6.4.1 Some proposals will improve sight lines not only for drivers but also for pedestrians. Additionally, some waiting restrictions on corners will discourage inconsiderate parking and improve pedestrian access to footways. This will be of benefit to both able bodied and disabled road users.

7.0 Recommendation

7.1 That subject to the views of this Board, the recommendations shown in appendix 1 are approved, and

7.2 That the proposals which require statutory consultation are advertised, and that any traffic related objections are reported back to a future meeting of the Board.

Contact Officer:	<i>Robin Chantrill-Smith (Civil Enforcement Manager) 01843 577472</i>
Reporting to:	<i>David Gonzalez (Commercial Services Manager) 01843 577690</i>

Background Papers None

Annex List	
<i>Annex 1</i>	<i>List of sites and site plans to be advertised.</i>

PARKING & WAITING REVIEW MARCH 2014

ANNEX 1 RECOMMENDATIONS

- JOINT SITE VISIT – KENT COUNTY COUNCIL/ TDC PARKING

REF	LOCATION	COMPLAINT	SITE VISIT	COMMENTS	PLAN
1	<u>Lyell Road</u> , Bircington.	Residents, TDC and KCC – are concerned about inconsiderate parking.	05/03/14 RCS, KG & LD	Agree. To extend existing lines to deal with sight lines and reduce potential vehicular conflict.	See site plan 1
2	<u>Green Lane</u> , Broadstairs.	TDC and KCC – are concerned about the parking of vehicles on the roundabout.	05/03/14 RCS, KG & LD	Agree. To extend Double Yellow Lines around the roundabout to deal with inconsiderate parking.	See site plan 2
3	<u>All Saints Avenue</u> , Margate.	Residents, and TDC – are concerned about non use of bays.	18/12/13 RCS, KG & LD	Agree. To remove Disabled bays and make them time limited bays.	See site plan 3
4	<u>Approach Road</u> , j/w Arundel Road, Margate	Residents, TDC and KCC – are concerned about inconsiderate parking.	05/03/14 RCS, KG & LD	Agree. To install Double Yellow line corner protection to deal with sight lines, reduce potential vehicular conflict.	See site plan 4
5	<u>Approach Road</u> , j/w Talbot Road, Margate	Residents, TDC and KCC – are concerned about inconsiderate parking.	05/03/14 RCS, KG & LD	Agree. To install Double Yellow line corner protection to deal with sight lines, reduce potential vehicular conflict.	See site plan 5
6	<u>Bath Road</u> j/w Clifton Street and Bath Place, Margate.	Residents, TDC and KCC – are concerned about inconsiderate parking.	18/12/13 RCS, KG & LD	Agree. To change Single Yellow Lines to Double Yellow Line corner protection on all junctions to deal with sight line issues, reduce potential vehicular conflict and to keep junction clear.	See site plan 6
7	<u>College Road</u> , Margate.	Residents, Members TDC and KCC – are concerned about inconsiderate parking.	18/12/13 RCS, KG & LD	Agree. To extend Double yellow lines from outside the clinic to the pedestrian crossing to deal with sight line issues, reduce potential vehicular conflict.	See site plan 7
8	<u>Northdown Road</u> , Margate	KCC and Stagecoach – are concerned about inconsiderate parking.	18/12/13 RCS, KG & LD	Agree. To change first bay from pay and display to double yellow lines with kerb markings to reduce potential vehicular conflict and improve sight lines.	See site plan 8

9	<u>Westfield Road</u> , j/w Argyle Avenue Margate.	Residents and Business's – are concerned about inconsiderate parking.	18/12/13 RCS, KG & LD	Agree. To install Double Yellow line corner protection to deal with sight lines, reduce potential vehicular conflict.	See site plan 9
10	<u>Canterbury Road West</u> , j/w Cliff View Road, Foads Hill, King Arthur Road and Arundel Road, Ramsgate.	KCC – are concerned about inconsiderate parking at the junctions.	05/03/14 RCS, KG & LD	Agree. To install Double Yellow Lines corner protection at all junctions to deal with sight line issues, reduce potential vehicular conflict and to keep junction clear.	See site plan 10
11	<u>Chapel Road</u> , j/w High Street St Lawrence, Ramsgate.	Residents are concerned about the lack of parking so could the lines be reduced to help with this issue.	05/03/14 RCS, KG & LD	Agree. To reduce the Double Yellow lines to 15 metres at the junction with High Street St Lawrence to help with parking issues.	See site plan 11
12	<u>Chapel Road</u> , Ramsgate.	Residents are concerned about the lack of parking so could the lines be reduced to help with this issue.	05/03/14 RCS, KG & LD	Agree. To reduce the Double Yellow lines to outside properties 18-24 to help with parking issues.	See site plan 12
13	<u>Eldon Grove</u> , j/w Wilsons Road, Ramsgate.	Residents, Members and TDC – are concerned about inconsiderate parking.	18/12/13 RCS, KG, LD	Agree. To install Double Yellow lines corner protection to deal with sight lines, to reduce potential vehicular conflict and keep the junction clear.	See site plan 13
14	<u>Foads Lane</u> , j/w Cottington Road, Ramsgate.	Residents, Parish Council, TDC and KCC – are concerned about inconsiderate parking.	05/03/14 RCS, KG & LD	Agree. Corner protection on junction to deal with sight line issues, reduce potential vehicular conflict and to keep junction clear.	See site plan 14
15	<u>Queen Street</u> , j/w Cliff Street, Ramsgate.	Residents, TDC and KCC – are concerned about inconsiderate parking.	18/12/13 RCS, KG, LD	Agree. To extend existing lines and place kerb markings to reduce potential vehicular conflict and keep access and junction clear.	See site plan 15
16	<u>Westwood Area</u> , Star Lane, Nash Road, New Link Road and Manston Court Road Margate.	KCC – are concerned about inconsiderate parking along new and existing roads.	18/09/13 RCS, KG & LD	Agree. To place double yellow lines along the new section of roads and extend existing lines to deal with sight line issues, reduce potential vehicular conflict and keep clear for access.	See site plan 16

Lyell Road Birchington Site Plan 1

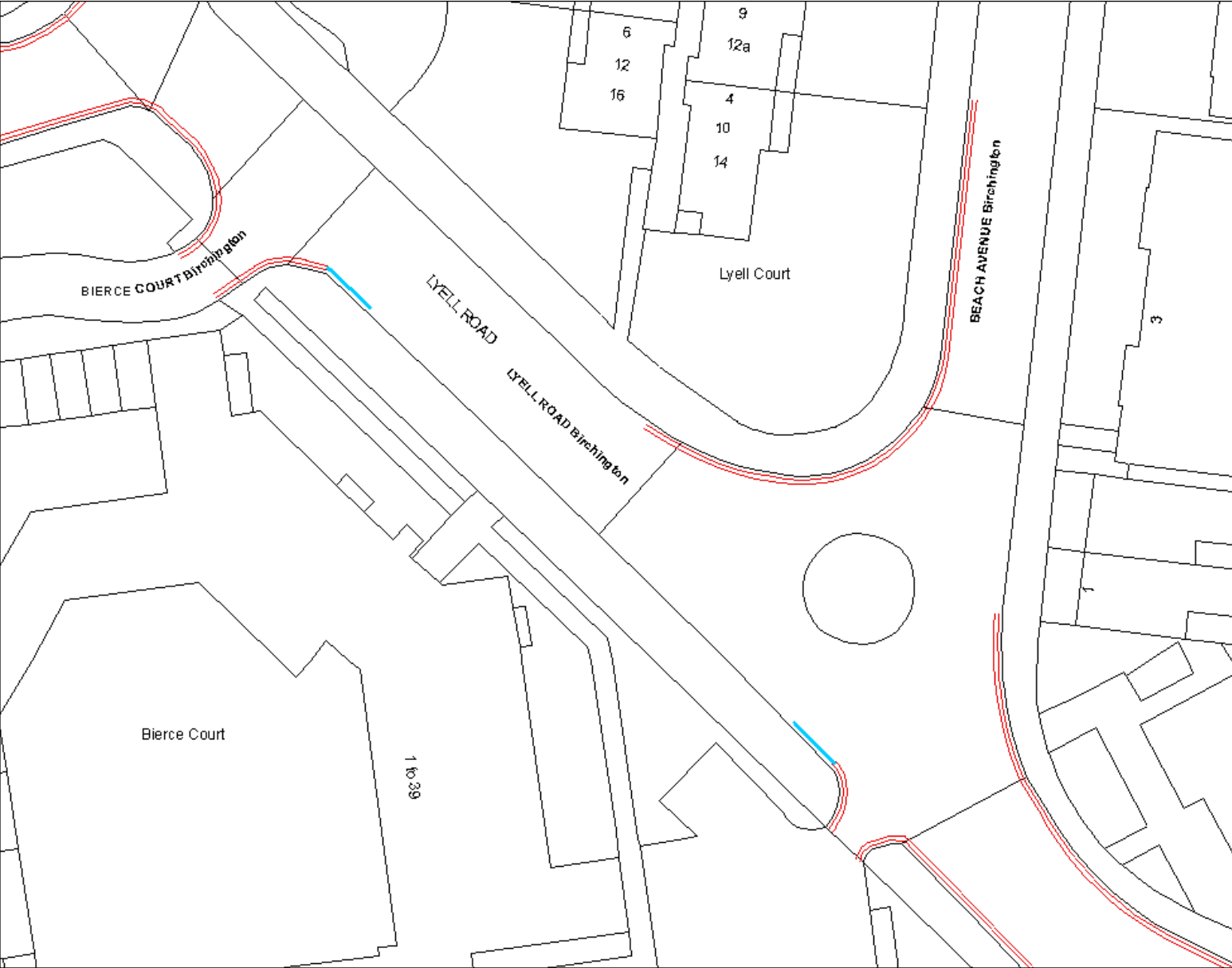

Proposed extending double yellow line corner protection



Site Plan 1
Lyell Road
Birchington

SLI 100018261

This page is intentionally left blank

Green Lane Broadstairs Site Plan 2

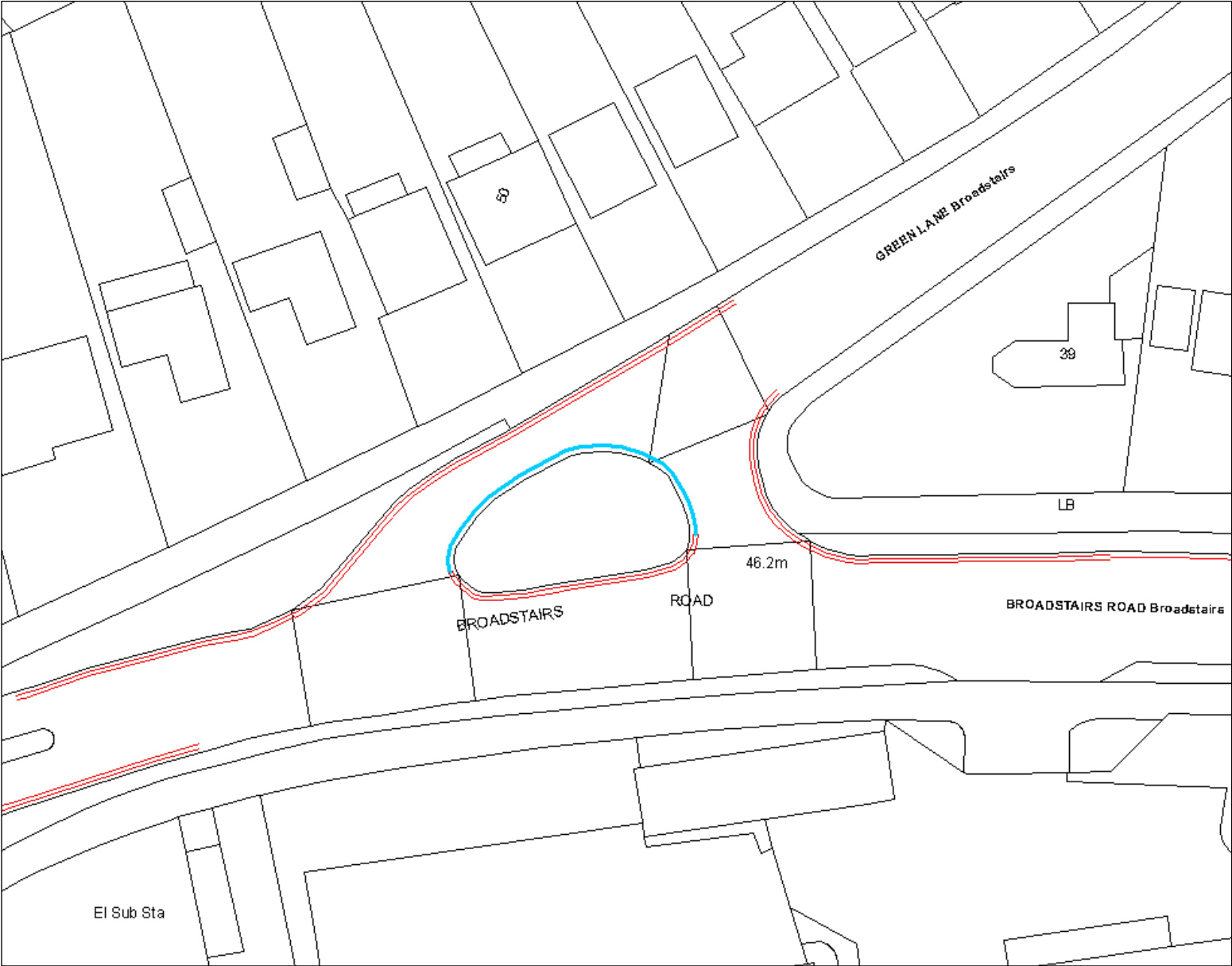

Proposed extending double yellow line around island.



Site Plan 2
Green Lane
Broadstairs

SLI 100018261

This page is intentionally left blank

All Saints Avenue Margate Site Plan 3

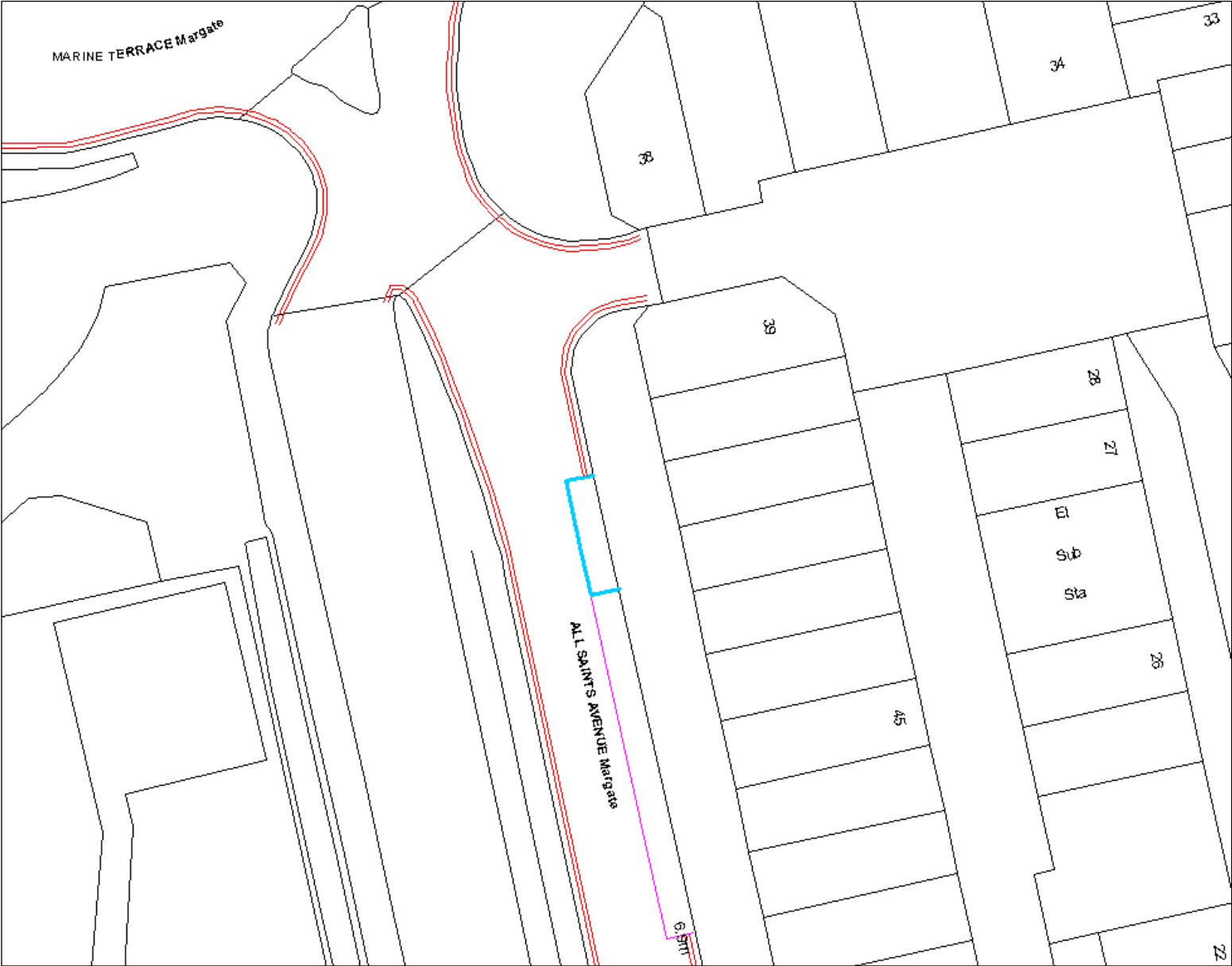

Proposed removal of disabled bay and change to time limited parking bays.



Site Plan 3
All Saints
Avenue
Margate

SLI 100018261

This page is intentionally left blank

Approach Road/Arundel Road Margate Site Plan 4

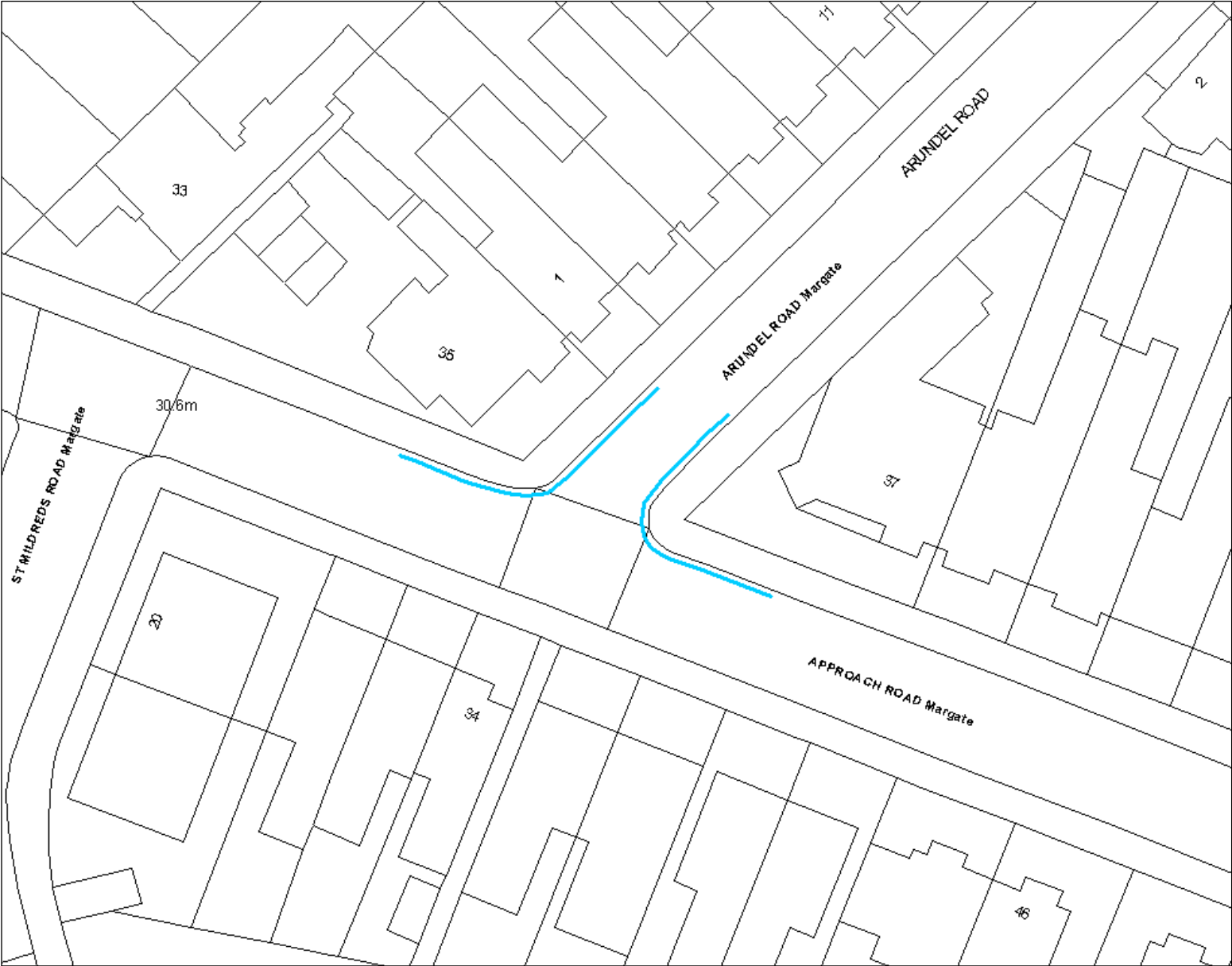

Proposed corner protection on the junction with Arundel Road



Site Plan 4
Approach Road j/w
Arundel Road
Margate

SLI 100018261

This page is intentionally left blank

Approach Road/Talbot Road Margate Site Plan 5

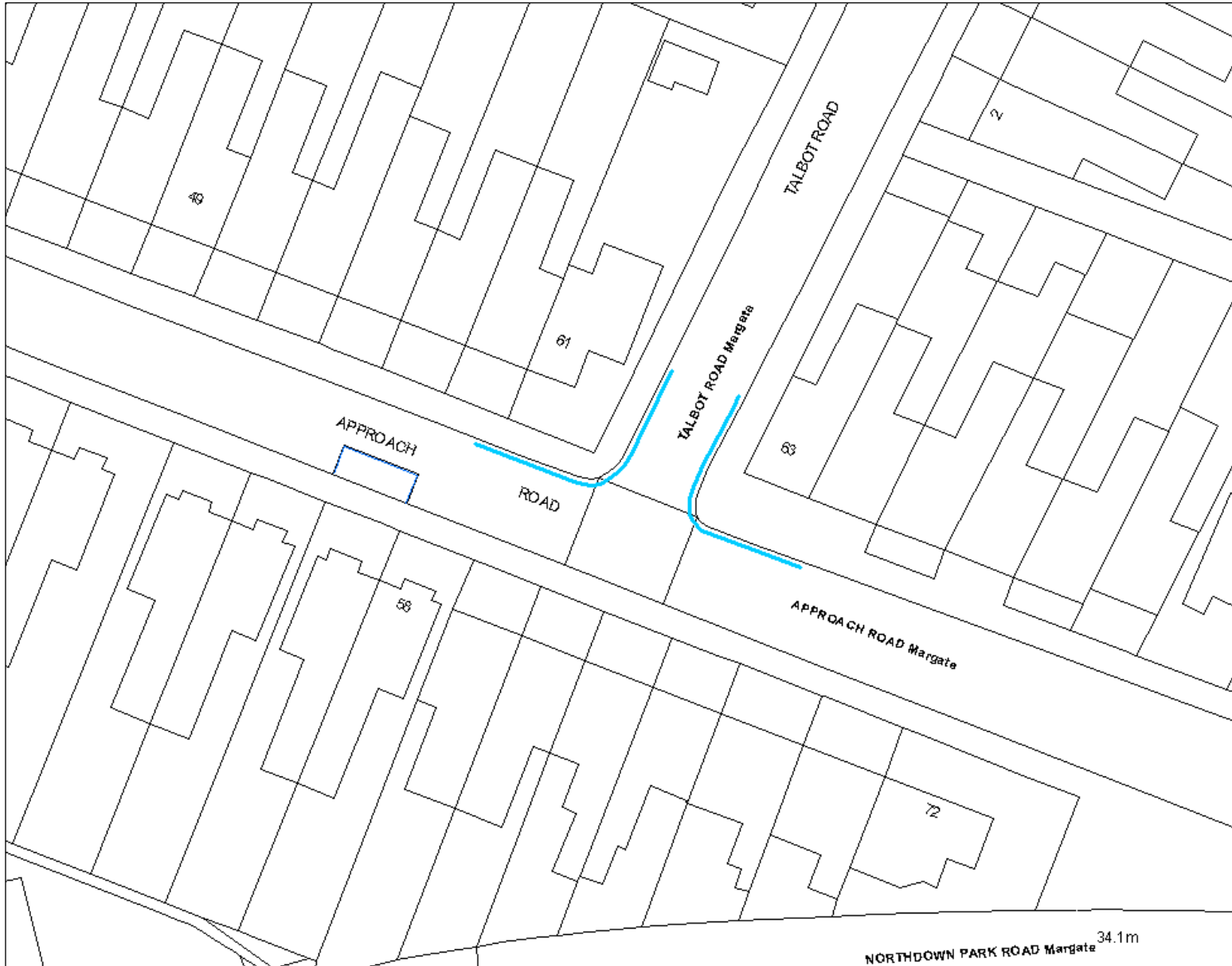

Proposed corner protection on the junction with Talbot Road



Site Plan 5
Approach Road
j/w Talbot Road
Margate

SLI 100018261

This page is intentionally left blank

Clifton Street/Bath Place Margate Site Plan 6

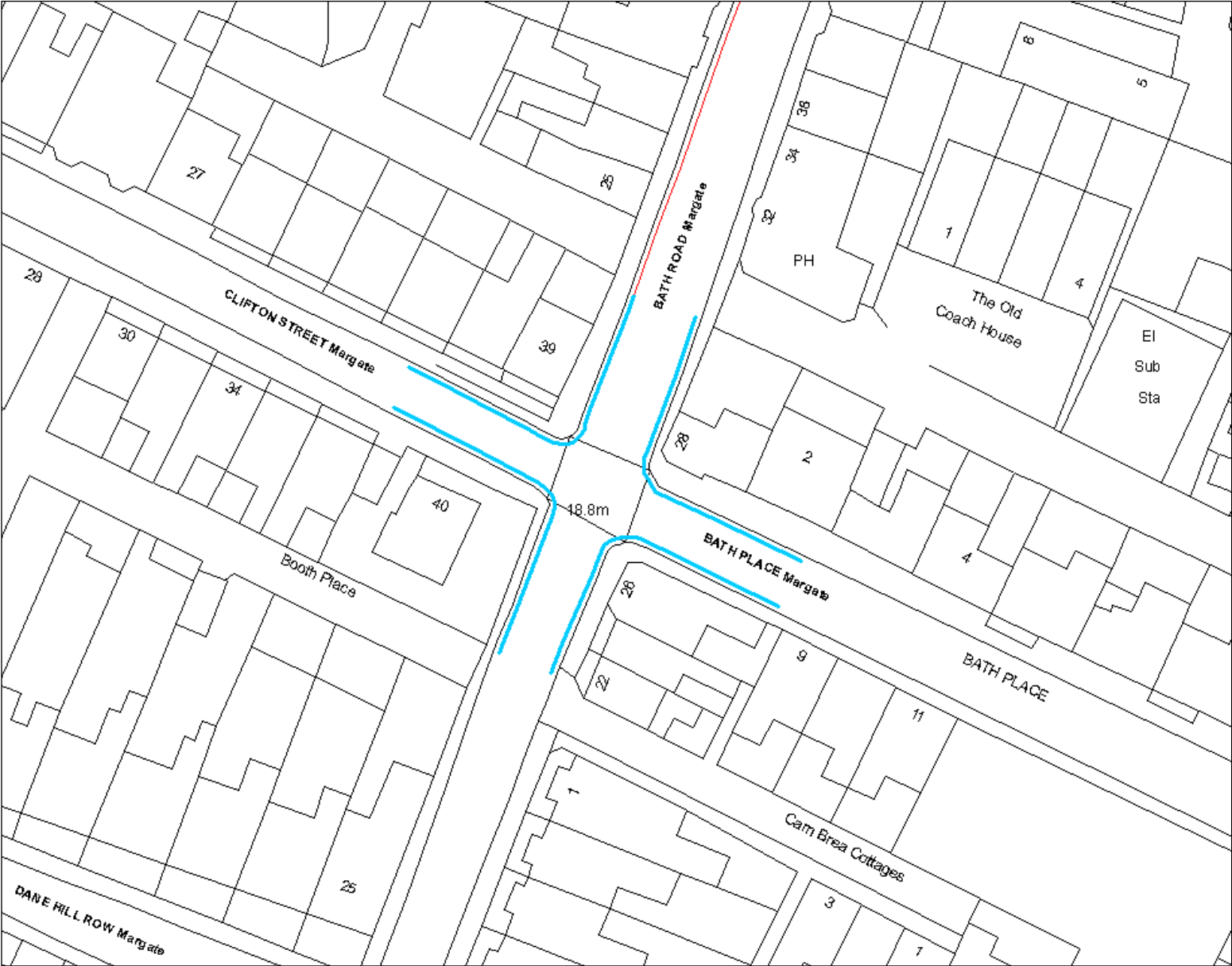

Proposed changing of single yellow line to double yellow line on the junctions



Site Plan 6
Bath Place
i/w Clifton
Street
Margate

SLI 100018261

This page is intentionally left blank

This page is intentionally left blank

Northdown Road Margate Site Plan 8



Proposed removal of Pay & Display bay by zebra crossing and replace with double yellow lines with waiting restrictions.



Site Plan 8
Northdown Road
Margate

SLI 100018261

This page is intentionally left blank

Westfield Road/Argyle Avenue Margate Site Plan 9

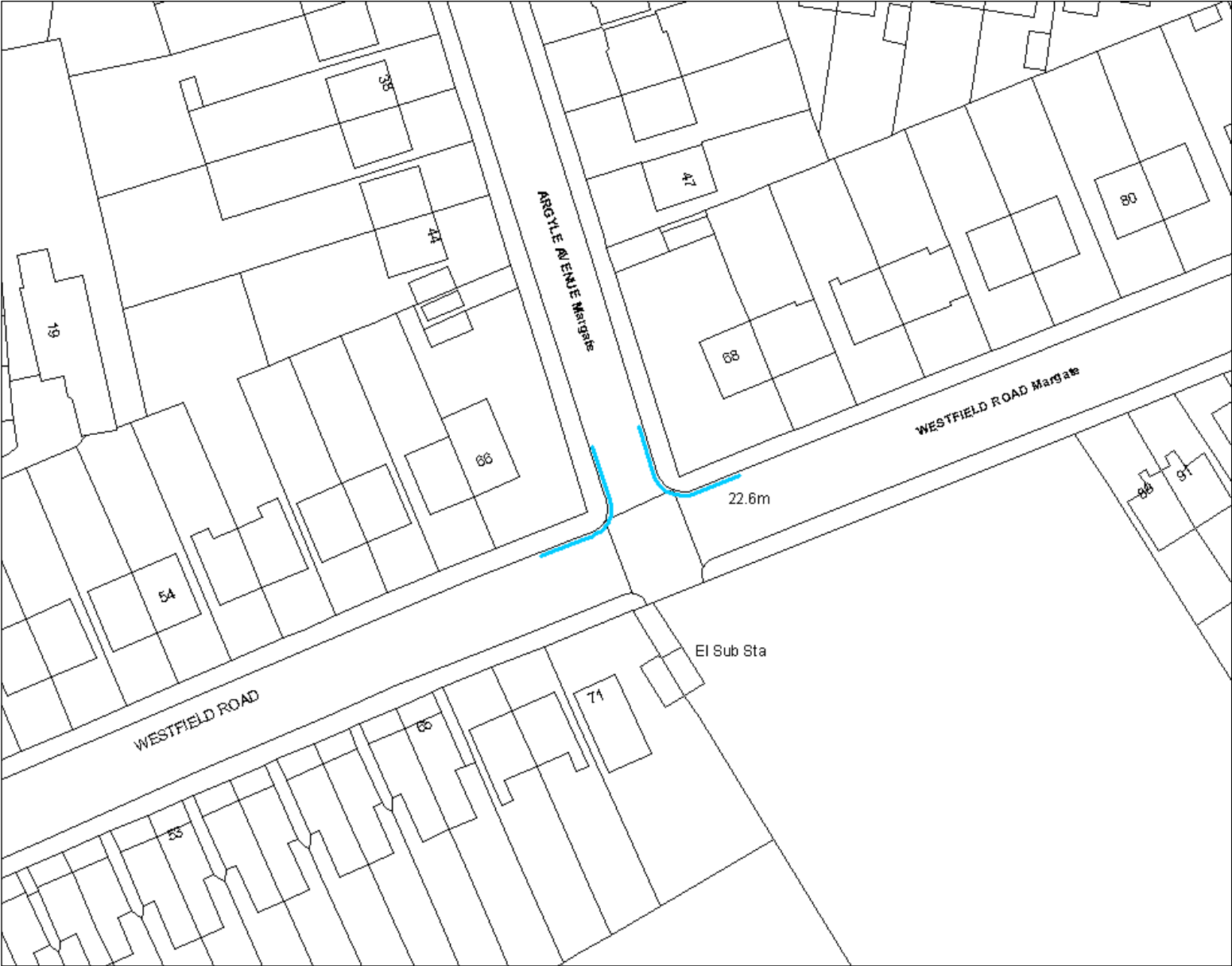

Proposed double yellow lines on the junction with Argyle Avenue



Site Plan 9
Westfield Road
j/w Argyle Avenue
Margate

SLI 100018261

Annex 10
Agenda Item 10

This page is intentionally left blank

Canterbury Road West Ramsgate Site Plan 10

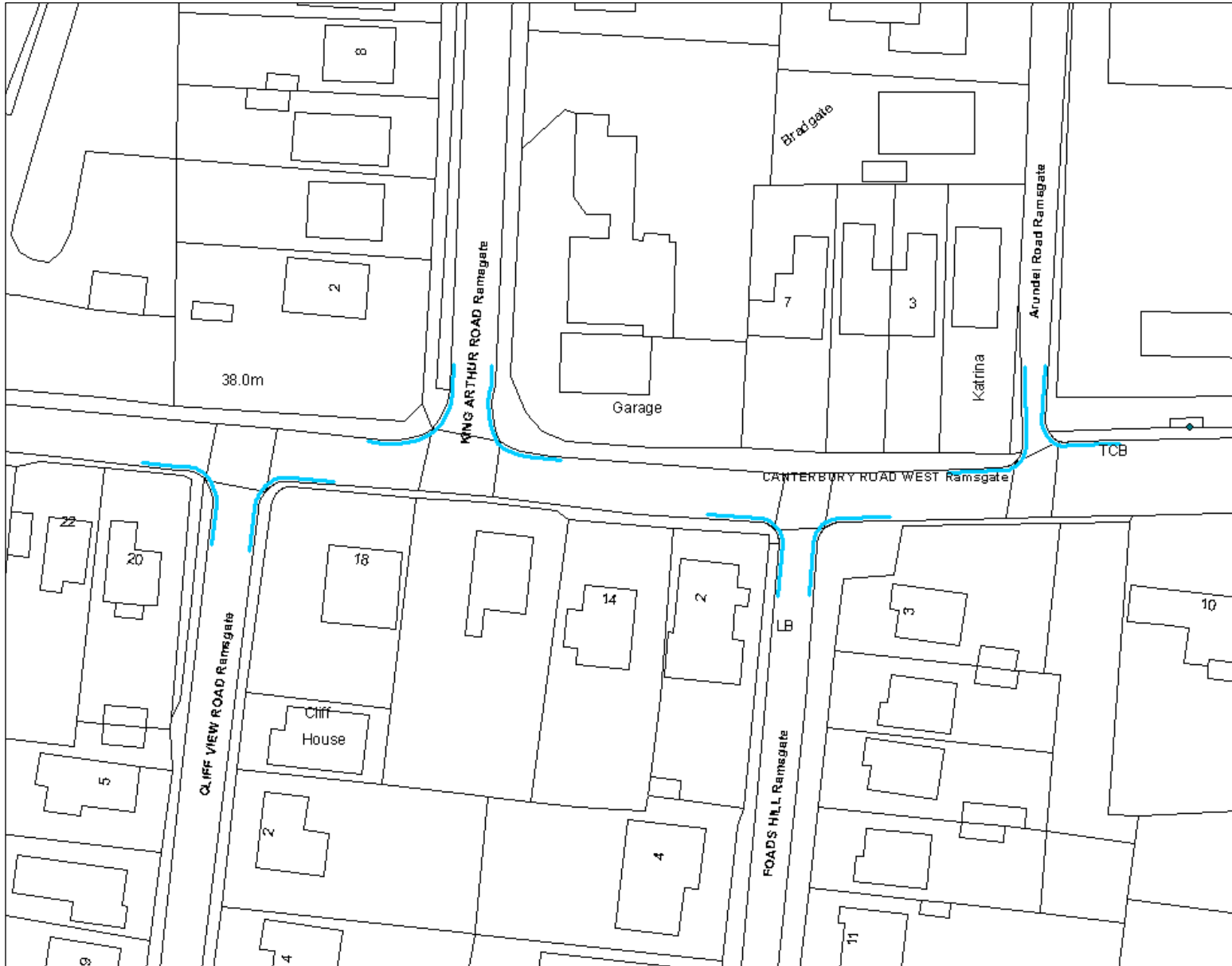

Proposed double yellow line corner protection with Cliff View Road, Foads Hill, King Arthur Road and Arundel Road



Site Plan 10
Canterbury Road West
j/w Cliff View Road

SLI 100018261

This page is intentionally left blank

Chapel Road/High Street Ramsgate Site Plan 11

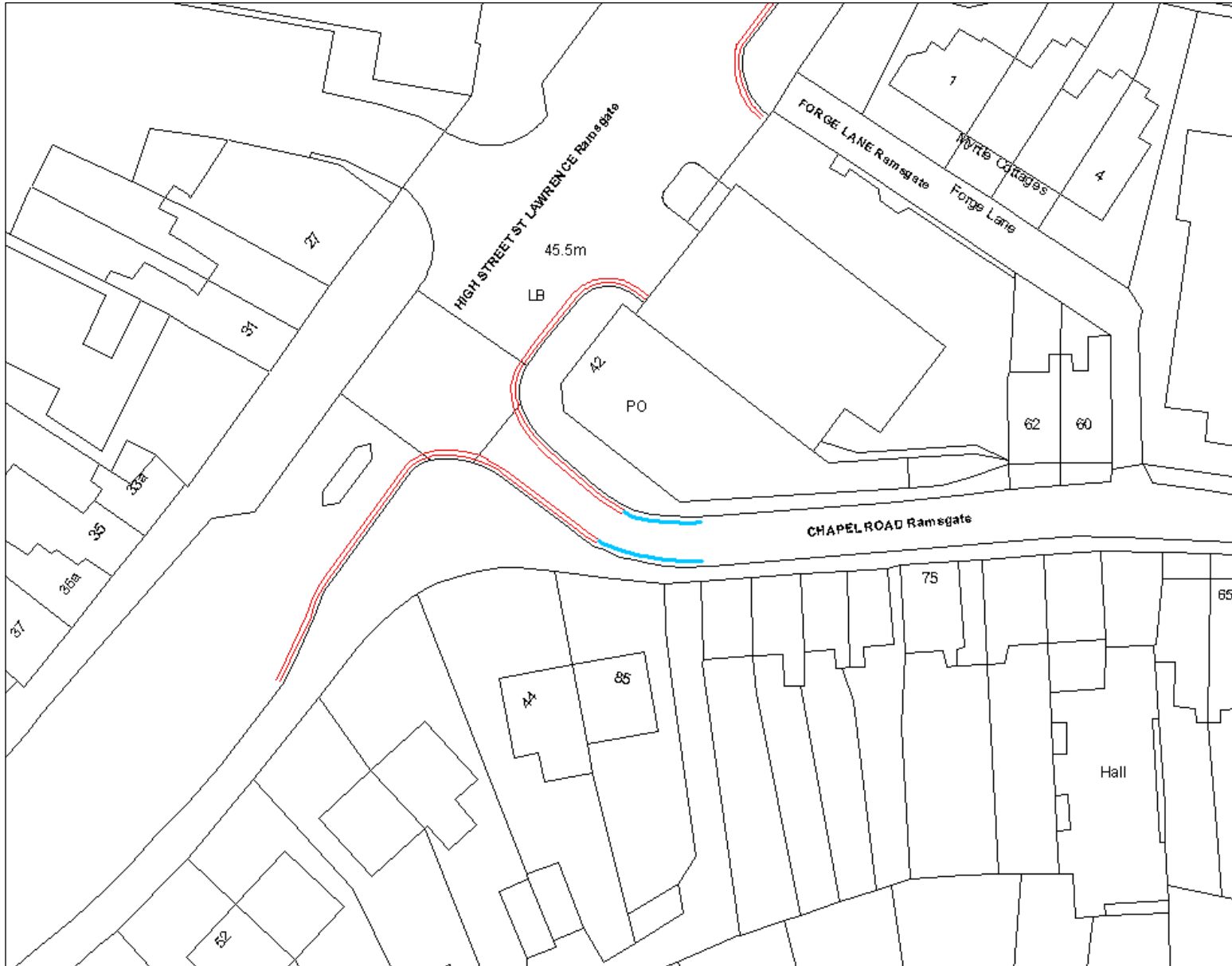

Reduction in double yellow lines



Site Plan 11
Chapel Road j/w
High Street
St Lawrence
Ramsgate

SLI 100018261

This page is intentionally left blank

Chapel Road Ramsgate Site Plan 12



Reduce double yellow lines with the junction with Claremont Gardens



Site Plan 12
Chapel Road
Ramsgate

SLI 100018261

This page is intentionally left blank

Eldon Grove Ramsgate Site Plan 13

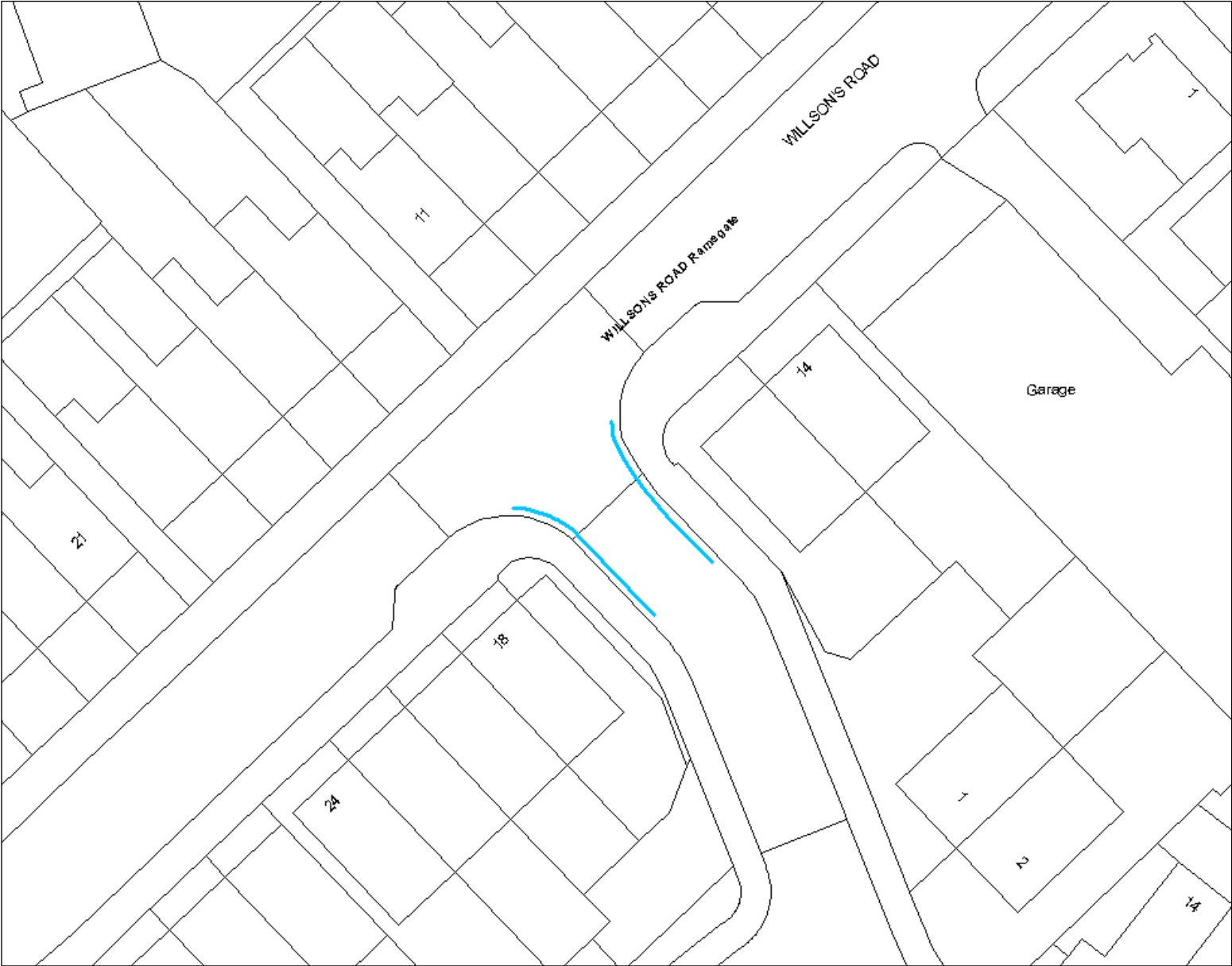

Corner protection on the junction with Willsons Road



Site Plan 13
Eldon Grove j/w
Willsons Road
Ramsgate

SLI 100018261

This page is intentionally left blank

Foads Lane/Cottingham Road Ramsgate Site Plan 14

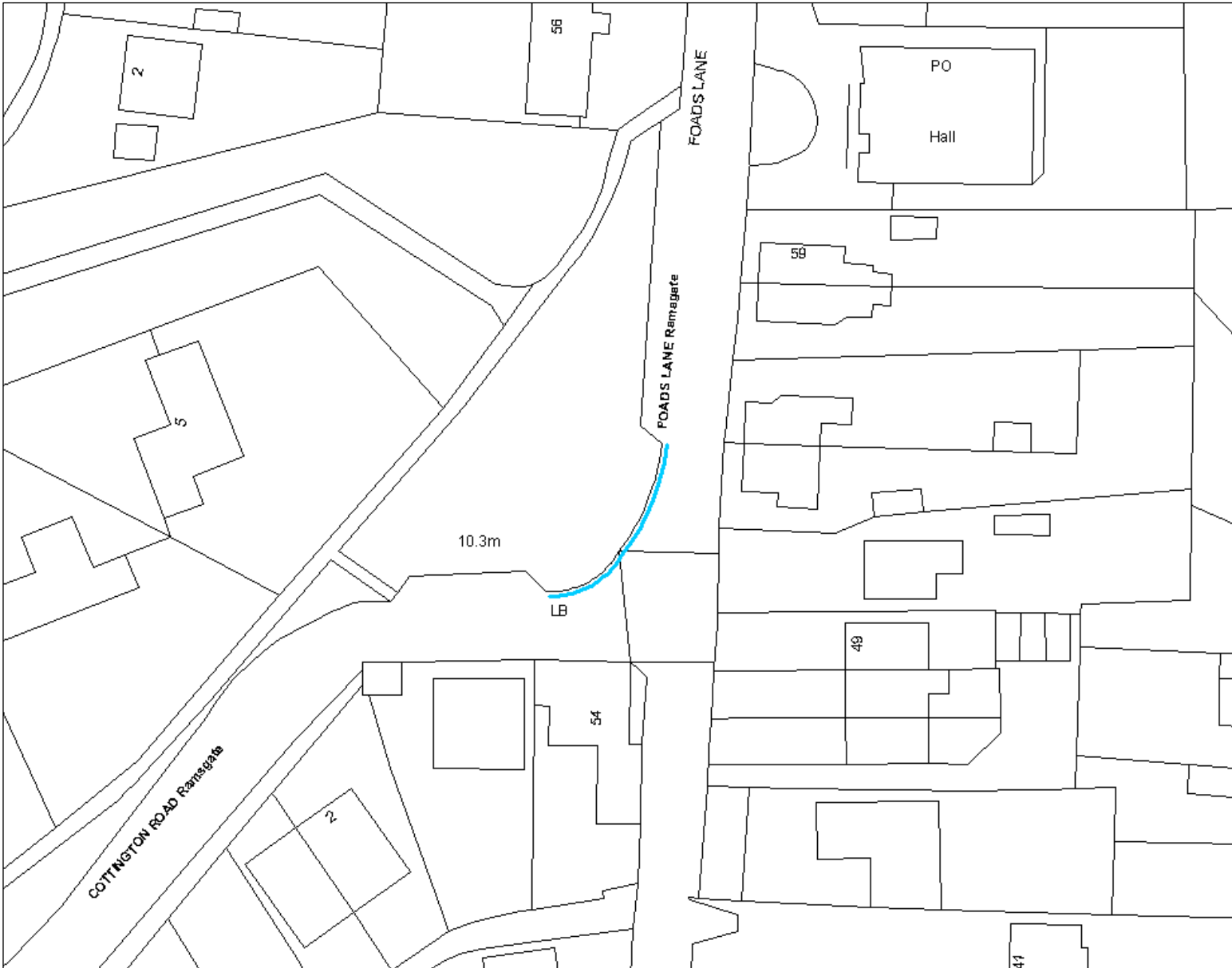

Proposed double yellow lines corner protection on the junction with Cottingham Road



Site Plan 14
Foads Lane j/w
Cottingham
Road
Ramsgate

SLI 100018261

This page is intentionally left blank

Queen Street/Cliff Street Ramsgate Site Plan 15

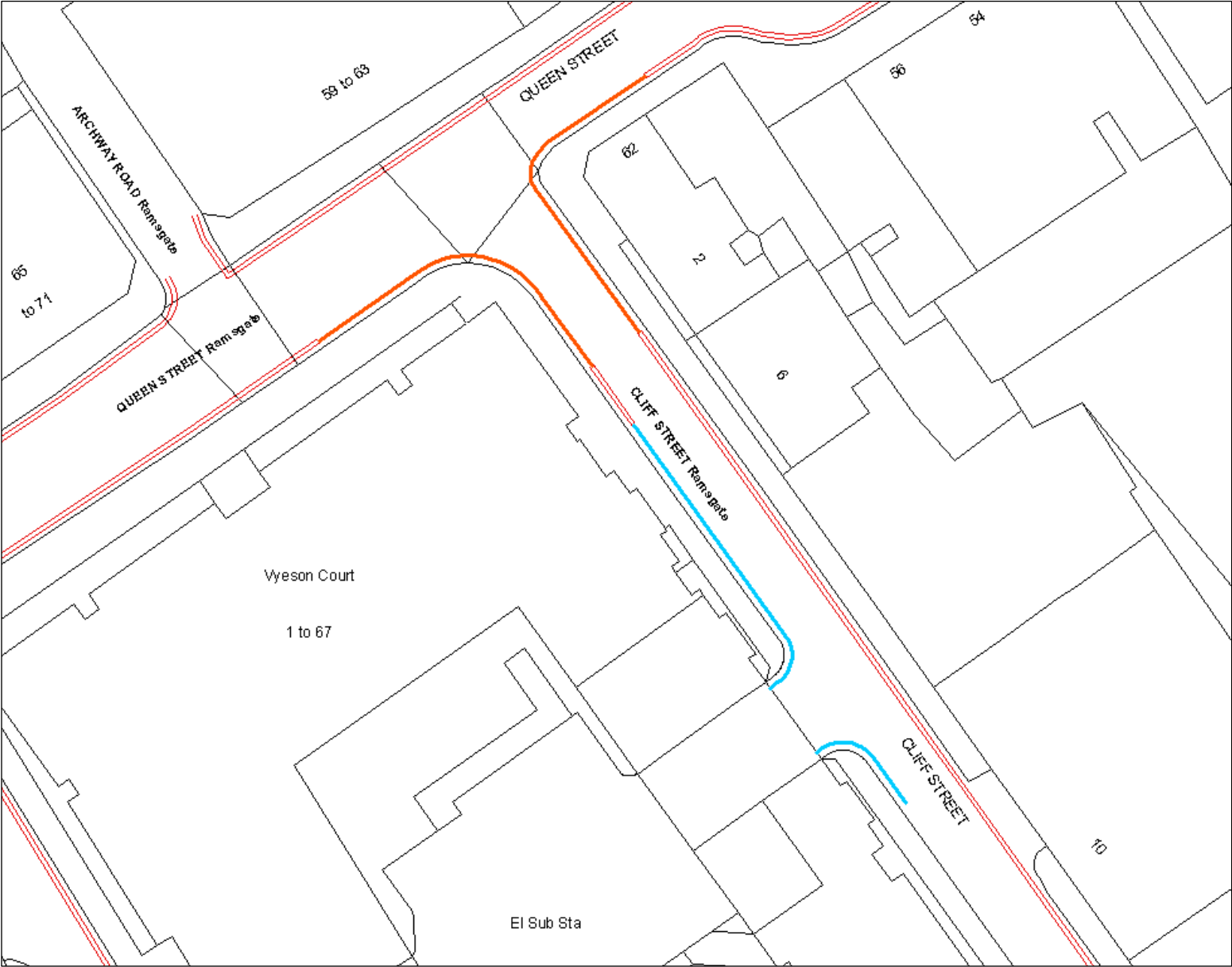

Proposed extending double yellow lines

Proposed waiting restrictions



Site Plan 15
Queen Street j/w
Cliff Street
Ramsgate

SLI 100018261

Annex 16
Agenda Item 10

This page is intentionally left blank

Poorhole Lane Westwood Site Plan 16

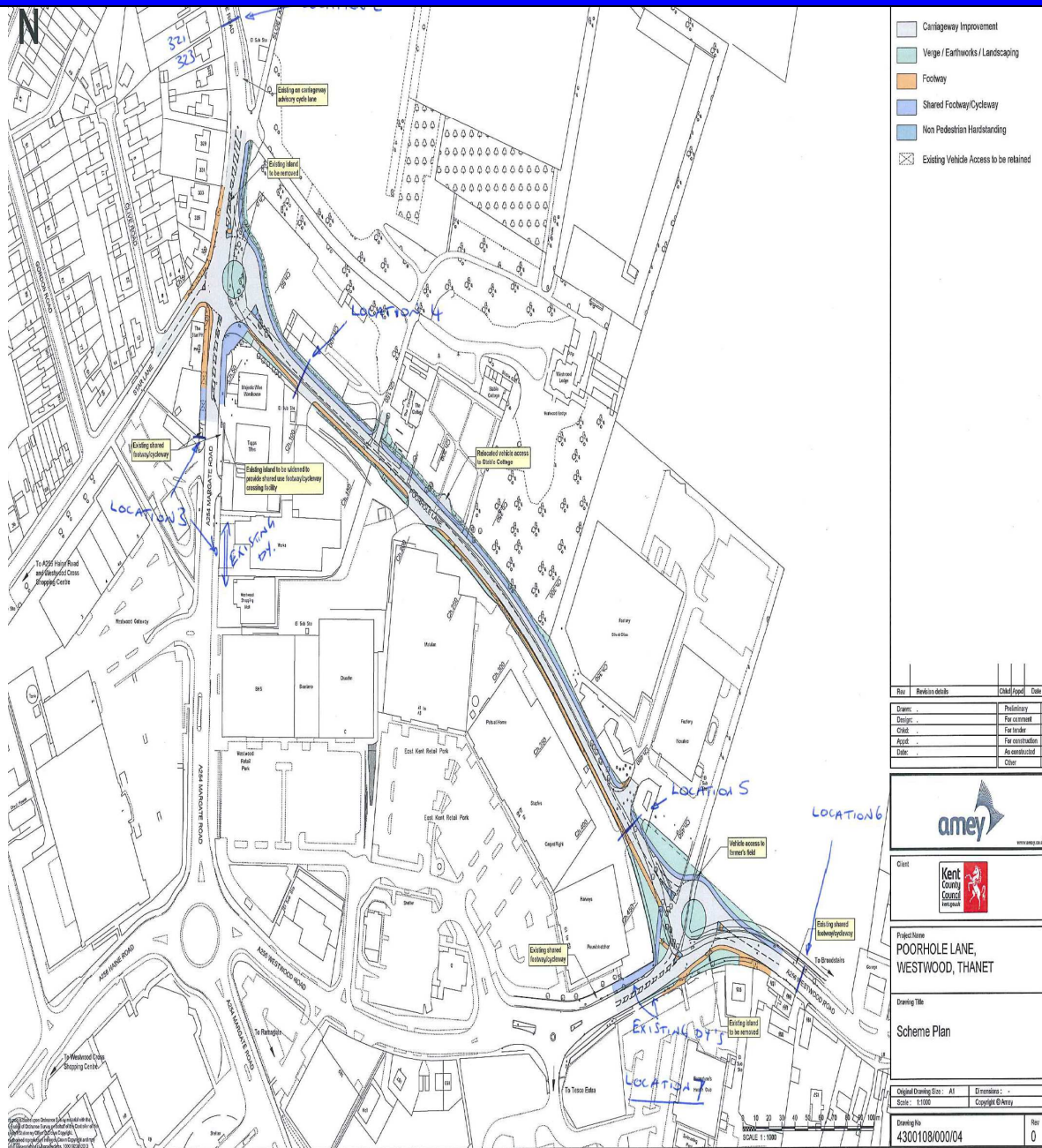

Proposed extension of Double Yellow Lines in Poorhole Lane, Margate Road and Westwood Road.



Site Plan 16
Westwood Area
Star Lane,
Nash Road,
New Link Road and
Manston Court Road
Margate

SLI 100018261

Rev	Revision details	Checked	Prepared	Date
Drawn			Preliminary	
Design			For comment	
Check			For tender	
Issue			For construction	
Date			As constructed	
			Other	



Client
Project Name
POORHOLE LANE,
WESTWOOD, THANET

Drawing Title
Scheme Plan

Original Drawing Size: A1
Scale: 1:1000
Drawing No: 4300108/000/04
Revision: 0

Annex 17
Agenda Item 10

This page is intentionally left blank

Parking & Waiting Restrictions – Update summary

To: **Thanet Joint Transportation Board – 27 March 2014**

By: **Civil Enforcement Manager**

Classification: **Information only.**

Ward: **Across the District - Various**

Summary: **This report provides an update and summarises schemes that have been through the Joint Transportation Board.**

For Decision

1.0 Introduction and Background

1. This report provides an update and summarises parking and waiting restrictions and any schemes that have been through the Joint Transportation Board and what stage in the process they have reached since the last meeting.

Parking and Waiting Restrictions – see Annex 1

2.0 Conclusion

2. This report is for Members information.

Contact Officer:	<i>Robin Chantrill-Smith (Civil Enforcement Manager) 01843 577472</i>
Reporting to:	<i>David Gonzalez (Commercial Services Manager) 01843 577690</i>

This page is intentionally left blank

PARKING & WAITING RESTRICTIONS UPDATE MARCH 2014

Annex 1

LOCATION	Description of Scheme	Date at JTB	Current Status
<u>Westbury Road</u> j/w St Mildred's Road and The Grove, Westgate.	Agree. Time limited controlled parking between the hours of 9 and 11am with 15m corner protection at both junctions to deal with sight line issues and to keep the junction clear.	15/03/12	Reject by residents.
<u>Cecil Street</u> , and <u>Hawley Square</u> Margate.	Agree. To install kerb markings from the junction with Cecil Square across of the Council Offices up to the boundary of 50/51 Hawley Square to deal with sight line issues, reduce potential vehicular conflict and to keep junction clear	19/12/13	Awaiting Consultation
<u>Cedar Close</u> j/w <u>Northdown Park Road</u> , Margate.	Agree. Double Yellow Line corner protection on junction to deal with sight line issues, reduce potential vehicular conflict and to keep junction clear.	19/12/13	Awaiting Consultation
<u>Farley Road</u> , Margate.	Agree. Double yellow lines from the junction with Ramsgate Road to deal with sight line issues, reduce potential vehicular conflict and to keep the junction clear.	19/12/13	Awaiting Consultation
<u>Hartsdown Road</u> , Margate	Agree. To extend double yellow lines to reduce potential vehicular conflict.	19/12/13	Awaiting Consultation
<u>Manston Road</u> , Margate.	Agree. To install single yellow lines form the junction with Shottendane Road on one side to the junction with Sycamore Close to reduce potential vehicular conflict.	19/12/13	Awaiting Consultation
<u>Tivoli Park Avenue</u> , j/w <u>Tivoli Road</u> , Margate.	Agree. To extend existing lines to reduce potential vehicular conflict and keep access clear.	19/12/13	Awaiting Consultation
<u>Wydhams Avenue</u> , j/w <u>Lyndhurst Avenue</u> , Margate.	Agree. To install Double Yellow Lines on one side of the junction for corner protection to keep the junction clear and reduce potential vehicular conflict.	19/12/13	Awaiting Consultation
<u>School Lane</u> , Ramsgate.	Agree. Corner protection on one side to reduce potential vehicular conflict.	19/12/13	Awaiting Consultation
<u>Southwood Road</u> , j/w <u>Southwood Heights</u> , Ramsgate.	Agree. Corner protection on junction to deal with sight line issues, reduce potential vehicular conflict and to keep junction clear.	19/12/13	Awaiting Consultation

<u>Westwood Area</u> , Star Lane, Nash Road, New Link Road and Manston Court Road Margate.	Agree. To place double yellow lines along the new section of roads and extend existing lines to deal with sight line issues, reduce potential vehicular conflict and keep clear for access.	19/12/13	Awaiting Consultation
<u>Queens Gardens</u> , Westcliff Avenue & Victoria Parade Broadstairs	Agree. Add into Broadstairs Victoria resident's scheme with shared pay and display	23/11/11	Scheme being drawn up and awaiting Consultation.
<u>High Street</u> , Margate	Agree. Extend hours of pedestrian access for Margate.	14/03/13	Informal Consultation May 2013. Order being drawn up.
<u>Harbour Street</u> , King Street, Queens Street, Ramsgate	Agreed. Extend days of pedestrian access for Ramsgate.	14/03/13	Informal Consultation May 2013. Order being drawn up.